

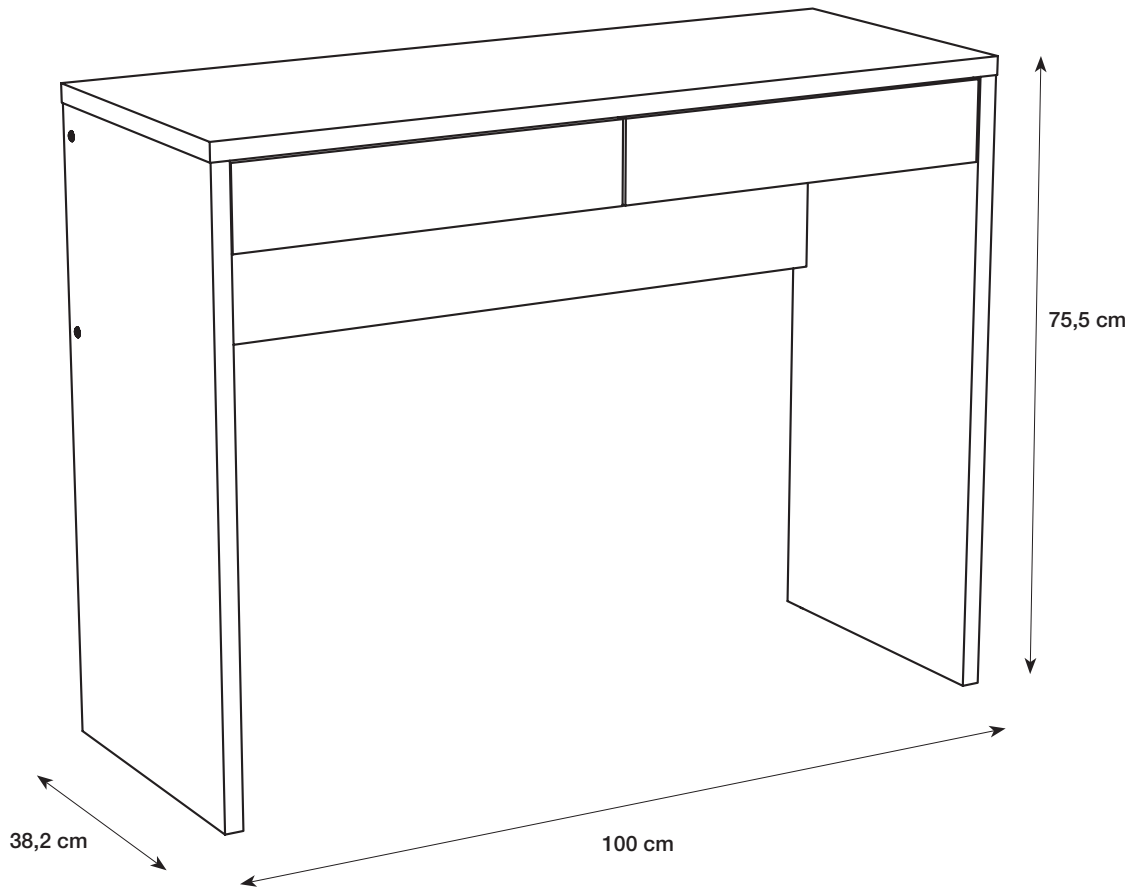

*Anna & Clara's*  
**DESK**





**EN:** DESK. L 100 x W 38,2 x H 75,5 cm. Flat-pack. Chipboard. Metal brackets. Screws: metal.

**Warning.** Incorrect assembly of the product can cause it to tip over/fall down and injure people or damage things. Contact your local DIY store for advice about the correct type of screws/rawl plugs for your type of wall to ensure that the fastening devices will withstand the forces generated. This product must be permanently fixed to the wall to avoid dangerous situations. Read the instructions thoroughly before assembling this product. Clean with a hard-wrung cloth. Do not use detergent. Wipe dry with a clean, dry cloth.

**DA:** SKRIVEBORD. L 100 x B 39 x H 40 cm. Saml selv. Spånplade. Metalbeslag. Skruer: metal.

**Advarsel.** Fejlmontering af produktet kan medføre, at produktet vælter/falder ned og laver skade på mennesker og ting. Kontakt Deres lokale byggemarked for at få råd og vejledning om valg af den rigtige type skruer/rawlplugs til Deres væg, så De kan være sikker på, at fastgørelsesanordningerne kan holde til belastningen. Dette produkt skal permanent fastgøres til væggen for at undgå farlige situationer. Læs brugsvejledningen grundigt igennem før samling af dette produkt. Rengøres med en hårdt opvredet klud. Brug ikke rengøringsmiddel. Tørres af med en ren, tør klud.

**NO:** SKRIVEBORD. L 100 x B 39 x H 40 cm. Flatpakket. Sponplate. Metallbeslag. Skruer: metal.

**Advarsel.** Hvis produktet monteres på feil måte, kan det velte / falle ned og skade mennesker og gjenstander. Kontakt Deres lokale byggemarked for råd og veiledning om valg av riktig type skruer/plugger til veggen Deres, slik at De kan være sikker på at festene tåler belastningen. Dette produktet skal festes permanent i veggen for å unngå farlige situasjoner. Les bruksanvisningen nøye før du setter sammen dette produktet. Rengjøres med en godt oppvridd klut. Ikke bruk rengjøringsmiddel. Tørkes av med en ren og tørr klut.

**SV:** SKRIVBORD. L 100 x B 39 x H 40 cm. Självmontering. Spånskiva. Metallbeslag. Skruvar: metall.

**Varning.** Felmontering av produkten kan leda till att produkten välter/faller ned och orsakar skador på människor och föremål. Kontakta ditt lokala byggvaruhus för råd och vägledning om hur du väljer rätt typ av skruvar/pluggar till din vägg, så att du kan vara säker på att fästelementen tål belastningen. Denna produkt måste fästas permanent på väggen för att undvika farliga situationer. Läs instruktionerna noggrant innan du monterar den här produkten. Rengör med en ordentligt urvriden trasa. Använd inte rengöringsmedel. Torka av med en ren, torr trasa.

**FI:** PÖYTÄ. P 100 x L 39 x K 40 cm. Koottava. Lastulevy. Metallikiinnikeet. Ruuvit: metalli.

**Varoitus.** Tuotteen virheellinen kokoaminen voi aiheuttaa tuotteen kaatumisen ja vahingoittaa ihmisiä ja/tai esineitä. Kysy paikallisesta rautakaupasta neuvoja ja ohjeita oikean tyyppisten ruuvien valitsemiseen seinällesi, jotta voit olla varma, että kiinnikkeet kestävät kuormituksen. Tämä tuote on kiinnitettävä pysyvästi seinään vaarallisten tilanteiden välttämiseksi. Lue käyttöohje huolellisesti ennen tämän tuotteen kokoamista. Puhdista kuivaksi puhdistetulla liinalla. Älä käytä pesuainetta. Pyyhi puhtaalla, kuivalla liinalla.

**DE:** SCHREIBTISCH. L 100 x B 39 x H 40 cm. Bausatz. Spanplatte. Metallhalterungen. Schrauben: Metall.

**Achtung.** Eine verkehrte Montage des Produkts kann dazu führen, dass das Produkt umkippt/umfällt und Personen oder Sachen zu Schaden kommen können. Wenden Sie sich an Ihren örtlichen Baumarkt, um sich bei der Auswahl der richtigen Art von Schrauben und Dübel für Ihre Wand beraten zu lassen. So können Sie sicher sein, dass die Befestigungselemente der Belastung standhalten. Dieses Produkt muss dauerhaft an der Wand befestigt werden, um gefährliche Situationen zu vermeiden. Bitte lesen Sie die Gebrauchsanweisung sorgfältig durch, bevor Sie dieses Produkt zusammenbauen. Mit einem gut ausgewrungenen Tuch reinigen. Kein Reinigungsmittel verwenden. Mit einem sauberen, trockenen Tuch abwischen.

**NL:** BUREAU. L 100 x B 39 x H 40 cm. Zelf monteren. Spaanplaat. Metalen beugels. Schroeven: metaal.

**Waarschuwing.** Onjuiste montage kan ertoe leiden dat het product kantelt/omvalt en schade aan mensen en voorwerpen veroorzaakt. Neem contact op met uw plaatselijke bouwmarkt voor advies en begeleiding bij het kiezen van het juiste type schroeven/pluggen voor uw muur, zodat u er zeker van kunt zijn dat de bevestigingsmiddelen de belasting aankunnen. Dit product moet permanent aan de muur worden bevestigd om gevaarlijke situaties te voorkomen. Lees de gebruiksaanwijzing zorgvuldig door voordat u dit product in elkaar zet. Reinig met een goed uitgewrongen doek. Gebruik geen schoonmaakmiddel. Veeg af met een schone, droge doek.

**FR:** BUREAU. L 100 x l 39 x H 40 cm. À monter soi-même. Panneau en aggloméré. Supports en métal. Vis : métal.

**Attention.** Un montage incorrect du produit peut le faire basculer ou tomber et blesser des personnes et causer des dommages aux biens. Contactez votre magasin de bricolage local pour obtenir des conseils et des recommandations sur le choix du bon type de vis / chevilles pour votre mur, afin d'être sûr que les fixations puissent résister à la charge. Ce produit doit être fixé au mur afin d'éviter les situations dangereuses. Lisez attentivement les instructions avant de monter ce produit. Nettoyer avec un chiffon bien essoré. Ne pas utiliser de détergent. Essuyer avec un chiffon propre et sec.

**IT:** SCRIVANIA. L 100 x l 39 x A 40 cm. Montaggio a cura dell'utente. Truciolato. Staffe in metallo. Viti: metallo.

**Attenzione/Avvertenza.** L'assemblaggio errato del prodotto può causare il ribaltamento/la caduta del prodotto procurando danni a persone e cose. Contatta il tuo negozio di bricolage di fiducia per consigli e indicazioni sulla scelta del tipo di viti/tasselli più adatto alla tua parete, in modo da essere sicuro che i dispositivi di fissaggio siano in grado di sostenere il carico. Per evitare situazioni di pericolo, fissare questo prodotto in modo permanente a una parete. Leggere accuratamente le istruzioni prima di assemblare il prodotto. Pulire con un panno ben strizzato. Non usare detersivi. Asciugare con un panno pulito e asciutto.

**ES:** ESCRITORIO. L 100 x An. 38,2 x Al. 75,5 cm. Kit de automontaje. Aglomerado. Soportes metálicos. Tornillos: metal.

**Advertencia.** El montaje incorrecto del producto puede hacer que vuelque o se caiga y cause daños a personas y objetos. Ponte en contacto con tu tienda de bricolaje local para que te orienten sobre la elección del tipo correcto de tornillos/tacos para tu pared, para que puedas estar seguro de que los dispositivos de fijación puedan soportar la carga. Para evitar situaciones peligrosas, este producto debe fijarse de forma permanente a la pared. Antes de montar este producto, lee atentamente las instrucciones. Si necesitas limpiarlo, utiliza un paño bien escurrido. No uses detergente. Para secarlo, utiliza un paño limpio y seco.

**PL:** BIURKO. D 100 x S 38,2 x W 75,5 cm. Paczka do samodzielnej montażu. Płyta wiórowa. Wsporniki metalowe. Śruby: metalowe.

**Ostrzeżenie.** Nieprawidłowy montaż produktu może spowodować jego przewrócenie się lub upadek, co może skutkować obrażeniami ciała lub uszkodzeniem mienia. Skontaktuj się z lokalnym sklepem budowlanym, aby uzyskać wskazówki dotyczące wyboru wkrętów/kołków rozporowych, które będą odpowiednie do danego typu ściany, co pozwoli mieć pewność, że elementy mocujące wytrzymają obciążenie. W celu uniknięcia niebezpiecznych sytuacji produkt należy trwale przymocować do ściany. Przed rozpoczęciem montażu produktu należy uważnie przeczytać instrukcję obsługi. Czyścić dobrze wyjętą szmatką. Nie należy używać detergentów. Wyczerć do sucha czystą, suchą szmatką.

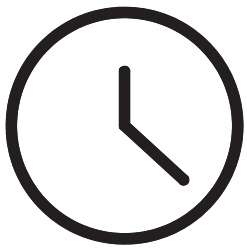
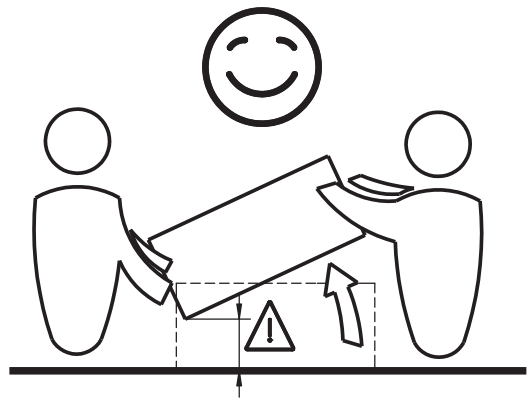
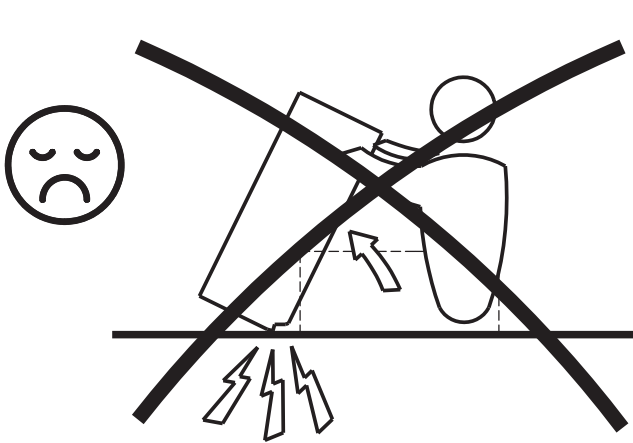
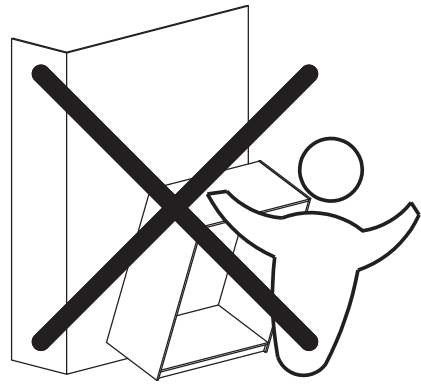
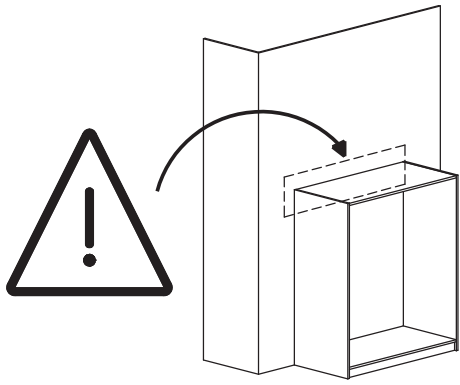

1-2 hr

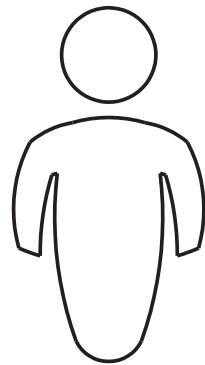

x2

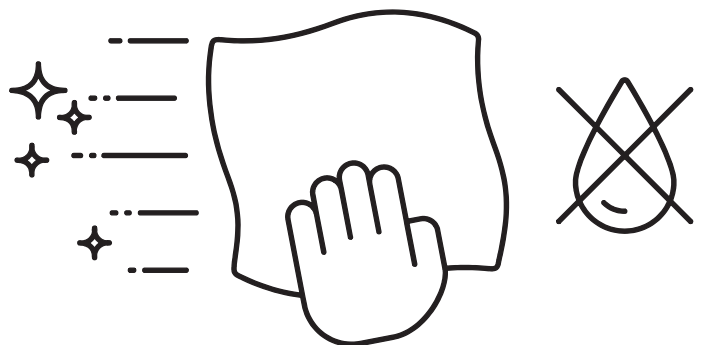
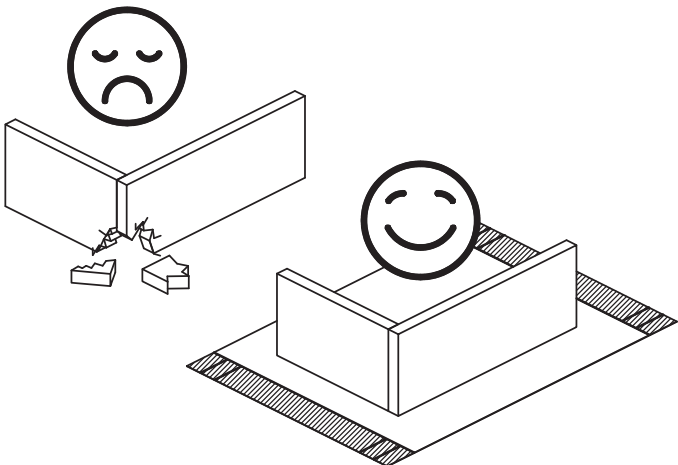

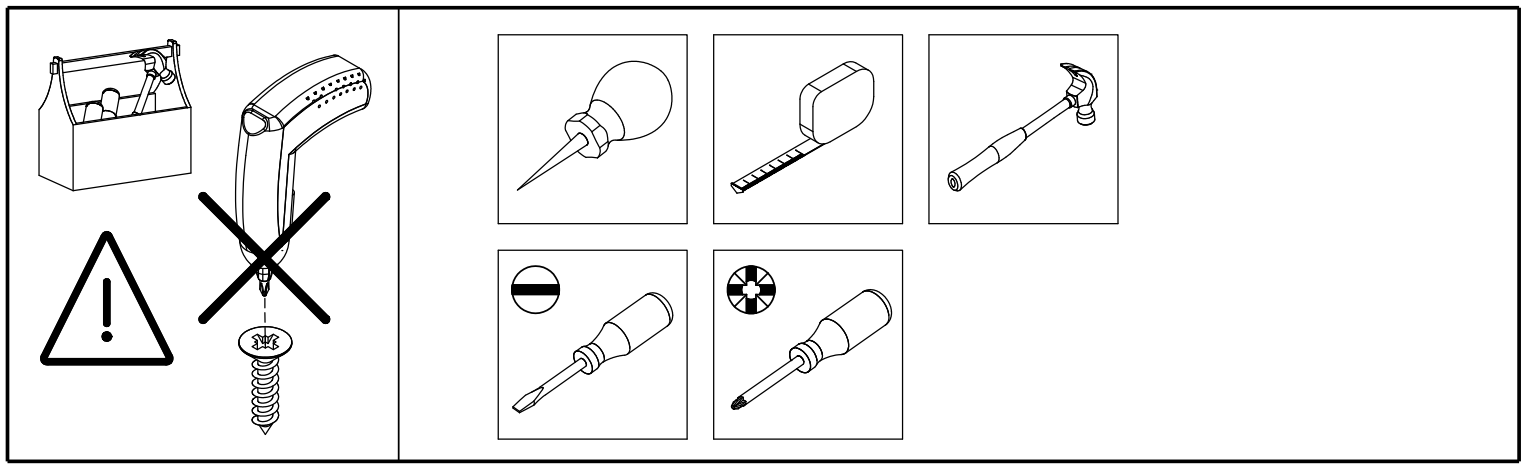

<p>0110901 <b>x1</b></p> <p>Ø0.87x0.02" Ø22x0,5 mm</p>	<p>0120203 <b>x18</b></p> <p>Ø0.2x1.18" Ø5x30 mm</p>	<p>0120228 <b>x8</b></p> <p>Ø0.25x1.57" Ø6,3x40 mm</p>	<p>0125233 <b>x8</b></p> <p>Ø0.14x0.59" Ø3,5x15 mm</p>	<p>0125288 <b>x1</b></p> <p>Ø0.18x1.77" Ø4,5x45 mm</p>
<p>0126020 <b>x8</b></p> <p>Ø0.23x0.35" Ø5,8x9 mm</p>	<p>0126214 <b>x4</b></p> <p>M4x0.35" M4x9 mm</p>	<p>0131513 <b>x12</b></p> <p>Ø0.30x1.77/1.34" Ø7,5x45/34 mm</p>	<p>0131561 <b>x4</b></p> <p>Ø0.28x2.02" Ø7x51,3 mm</p>	<p>0131687 <b>x16</b></p> <p>Ø0.59x0.37" Ø15x9,5 mm</p>
<p>0141403 <b>x4</b></p> <p>0.67x9.69/9.88" 17x246/251 mm</p>	<p>0163001 <b>x4</b></p> <p>Ø0.47x0.16" Ø12x4 mm</p>	<p>0194009 <b>x2</b></p> <p>1.97x3.54x0.47" 50x90x12 mm</p>		

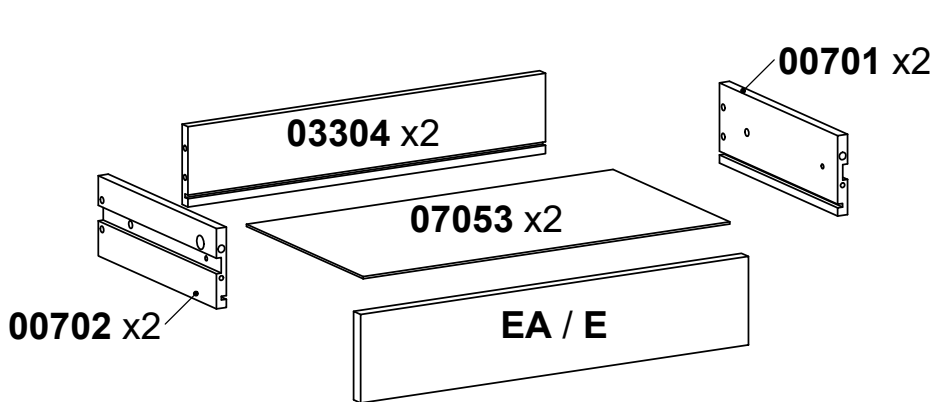
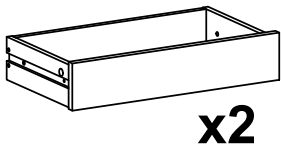
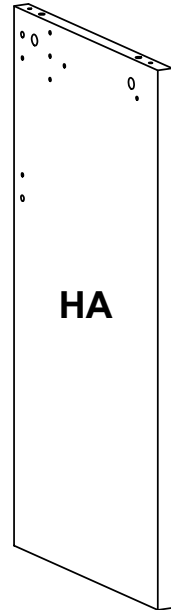
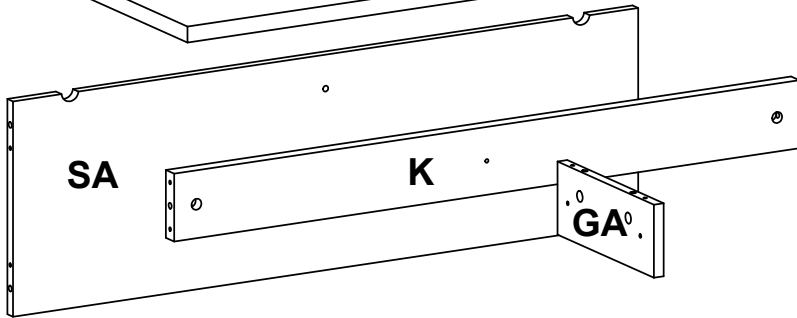
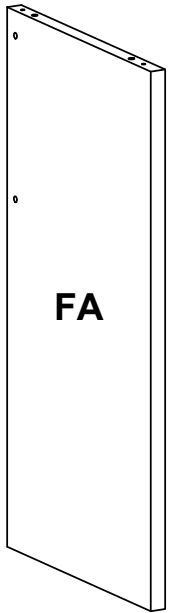
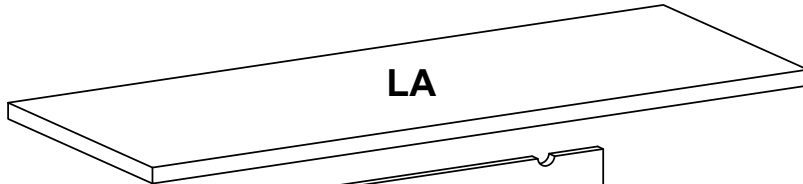
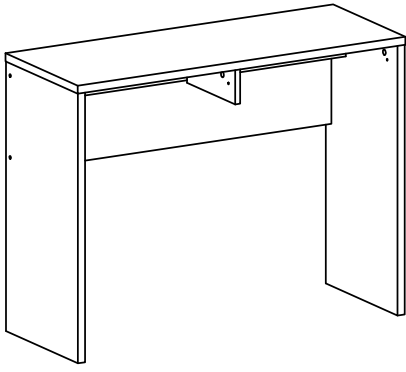

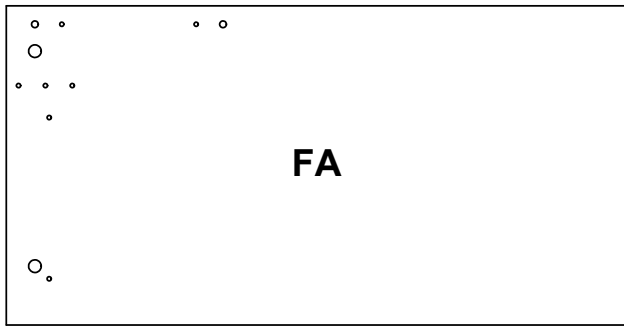

739x380x22mm

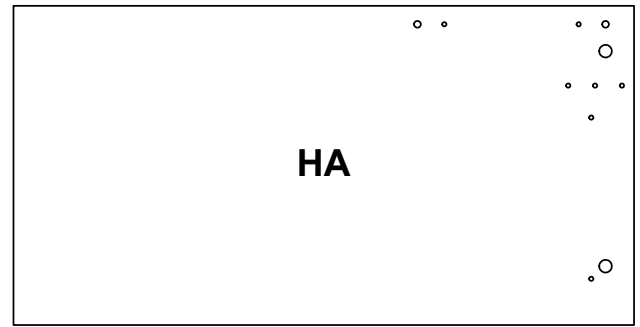

739x380x22mm

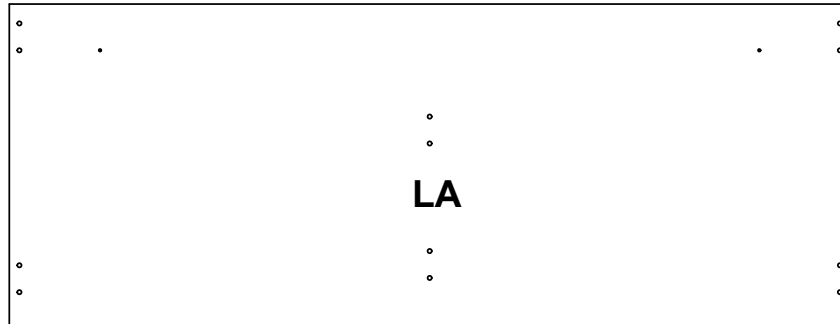

1001x382x22mm

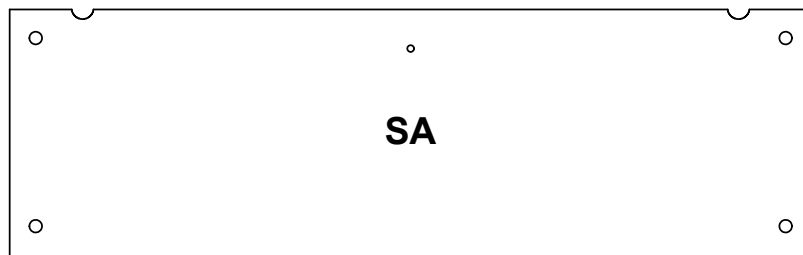

955x295x15mm



955x93x22mm



474x97x15mm

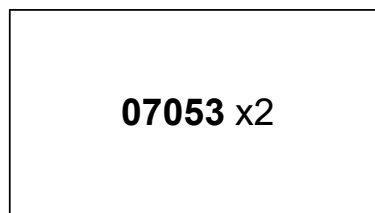

448x247x2,5mm

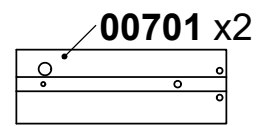

250x88x12,2mm



474x97x15mm

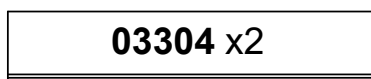

437x88x12,2mm



100x255x15mm

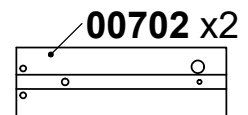

250x88x12,2mm

# 1

0125233 x2  
Ø0.14x0.59"  
Ø3,5x15 mm

0126020 x2  
Ø0.23x0.35"  
Ø5,8x9 mm

0141403 x1  
0.67x9.69/9.88"  
17x246/251 mm

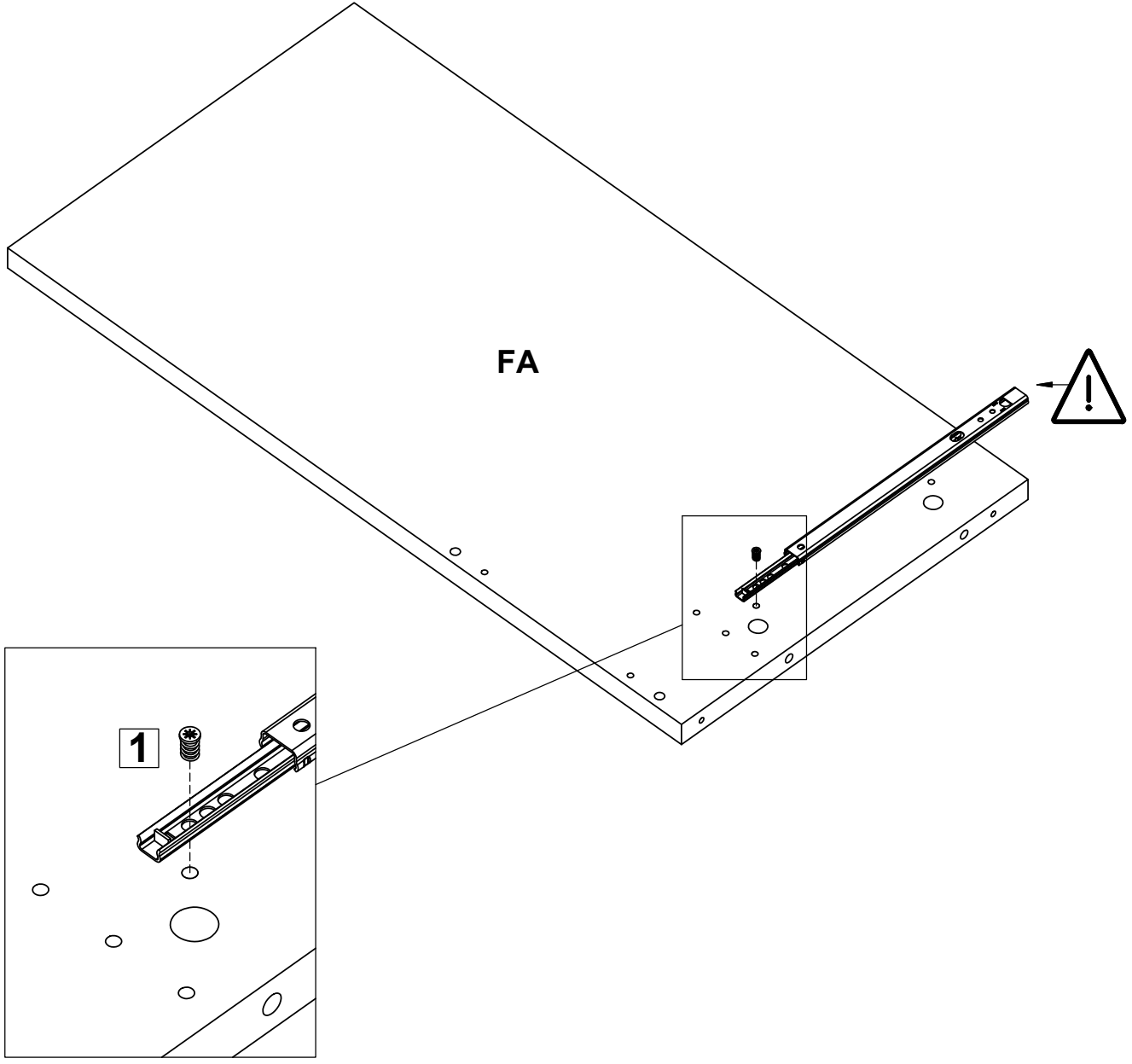
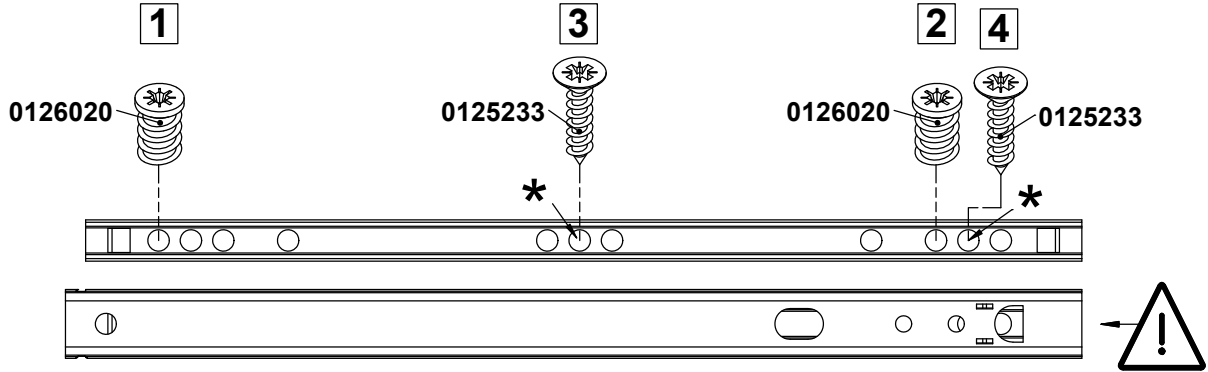
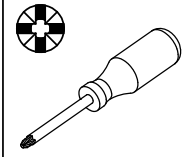
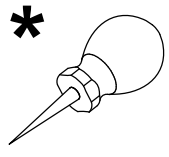

2

0131513

x1

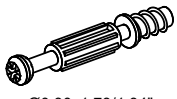

Ø0.30x1.73/1.34"  
Ø7,5x44/34 mm

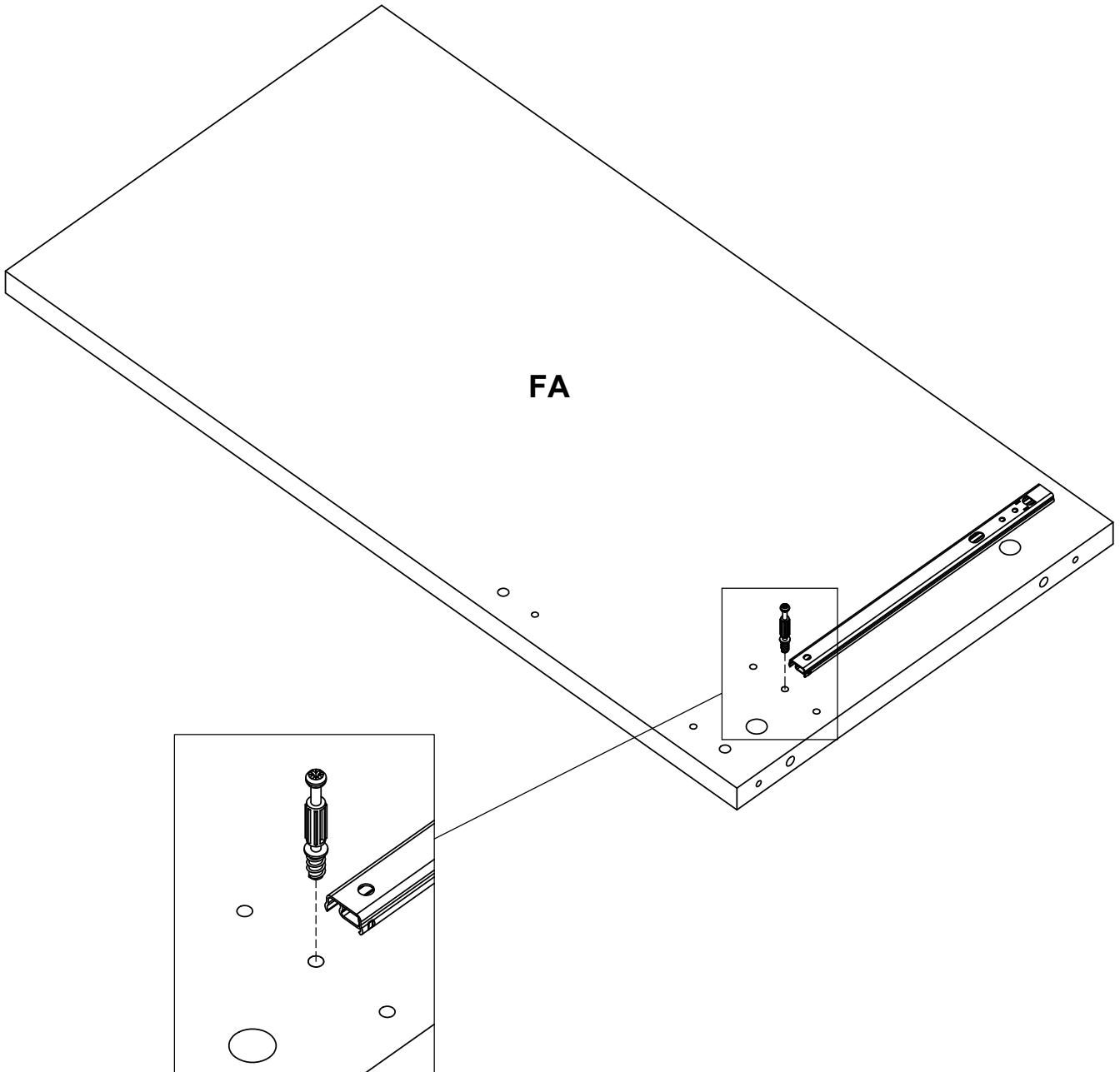
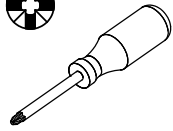

# 3

0125233 x2  
Ø0.14x0.59"  
Ø3,5x15 mm

0126020 x2  
Ø0.23x0.35"  
Ø5,8x9 mm

0141403 x1  
0.67x9.69/9.88"  
17x246/251 mm

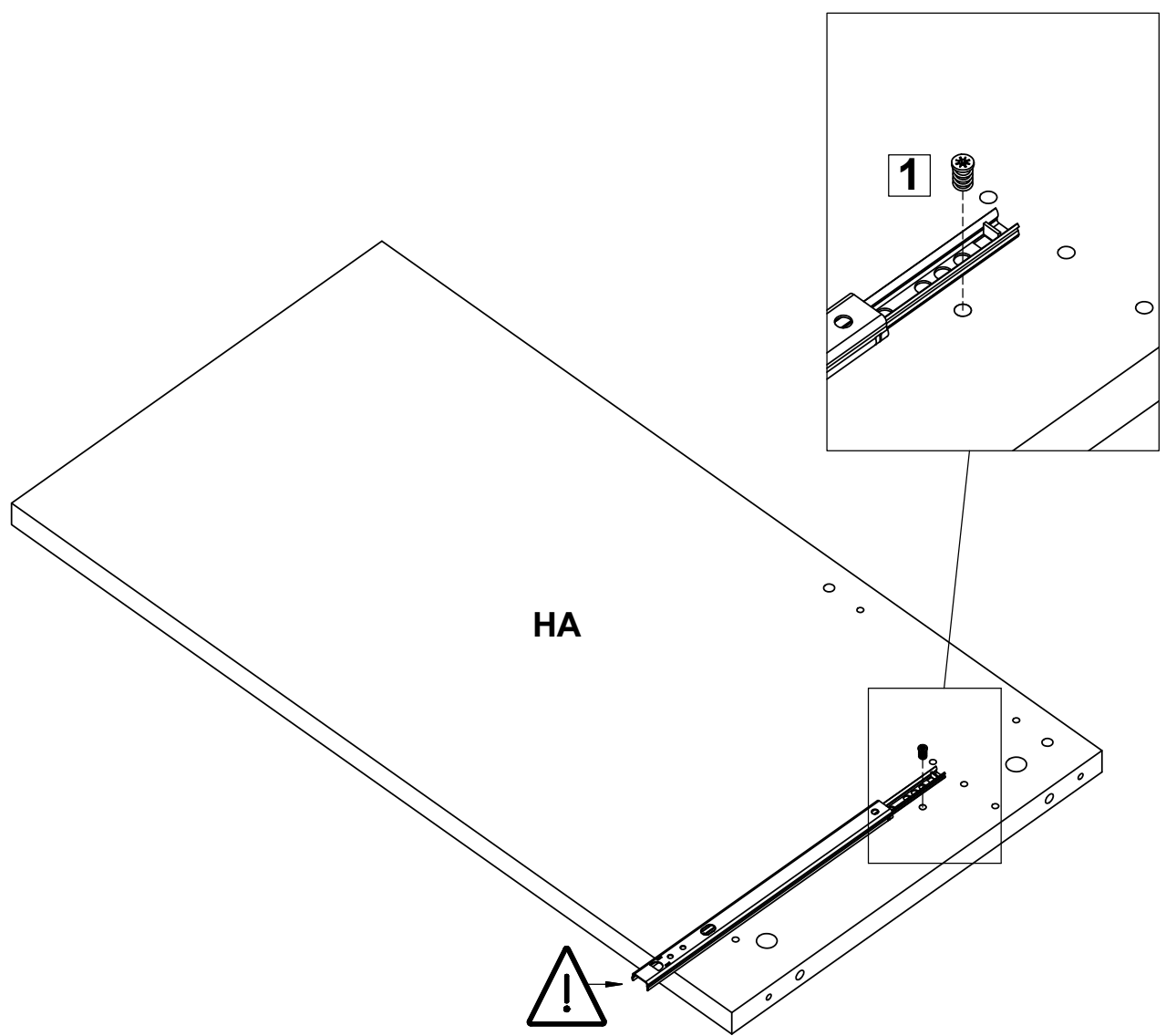
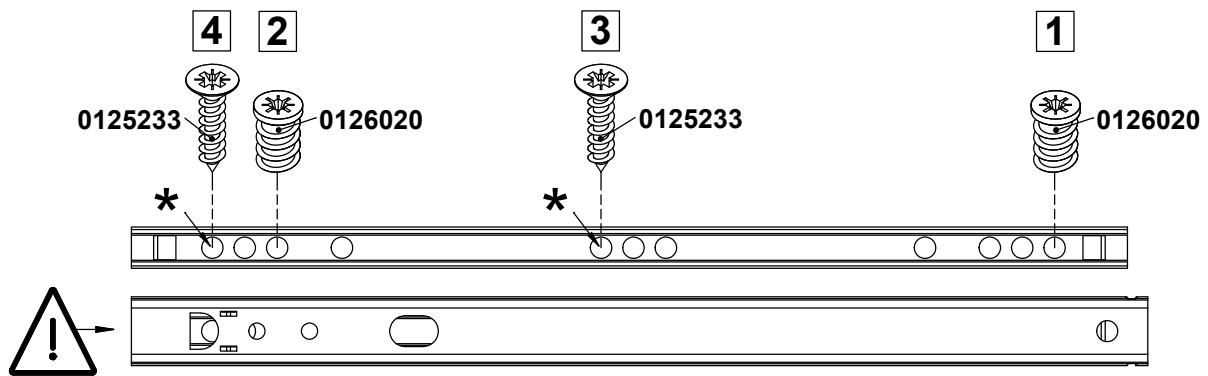
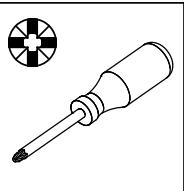
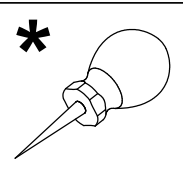

4

0131513

x1

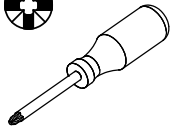
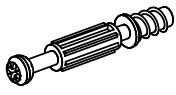

Ø0.30x1.73/1.34"  
Ø7,5x44/34 mm

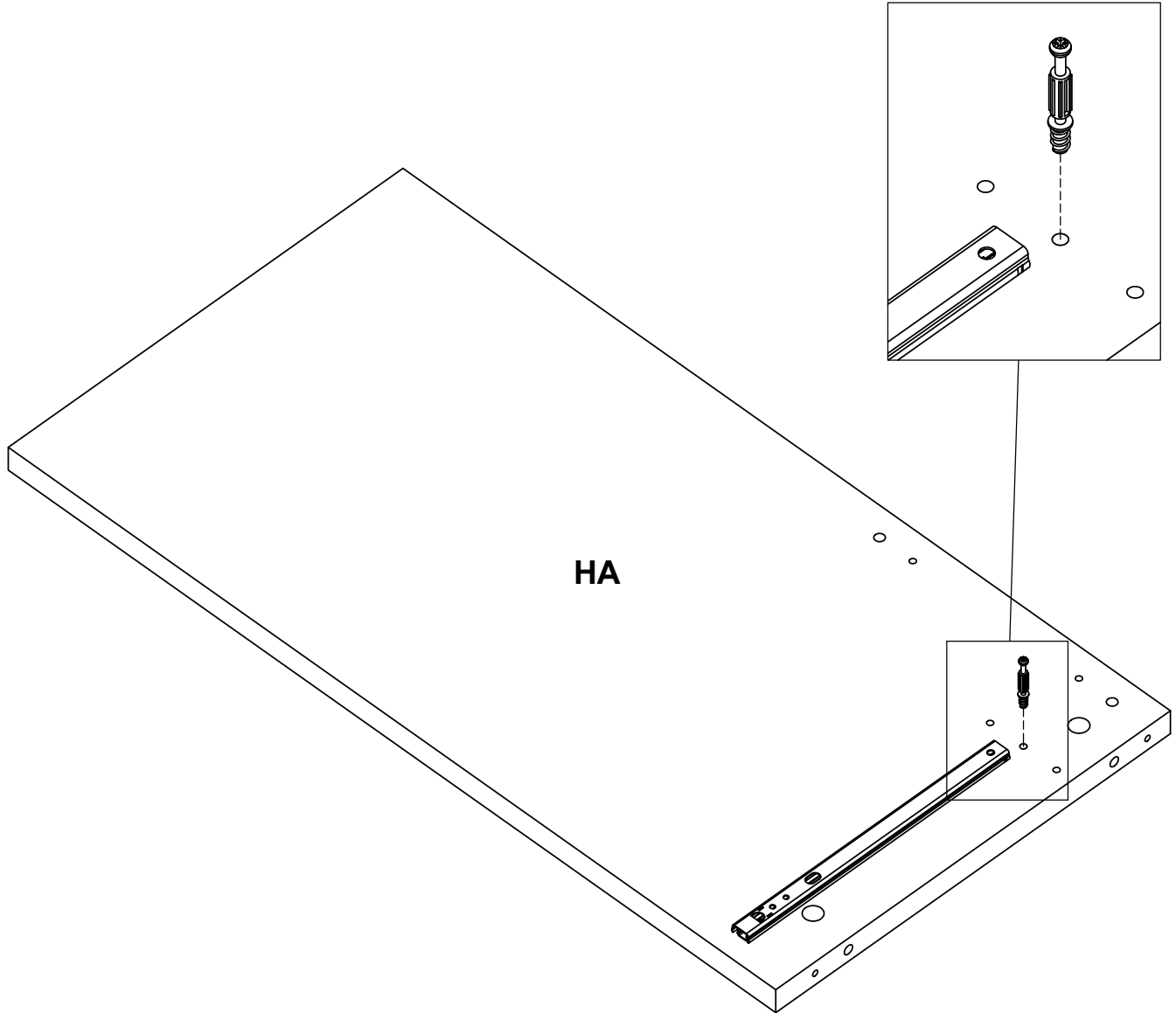

# 5

0125233

x2

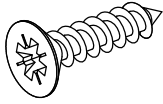

Ø0.14x0.59"  
Ø3.5x15 mm

0126020

x2

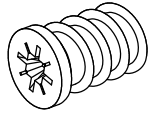

Ø0.23x0.35"  
Ø5.8x9 mm

0141403

x1

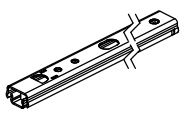

0.67x9.69/9.88"  
17x246/251 mm

\*

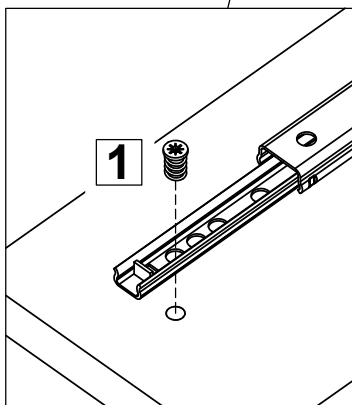
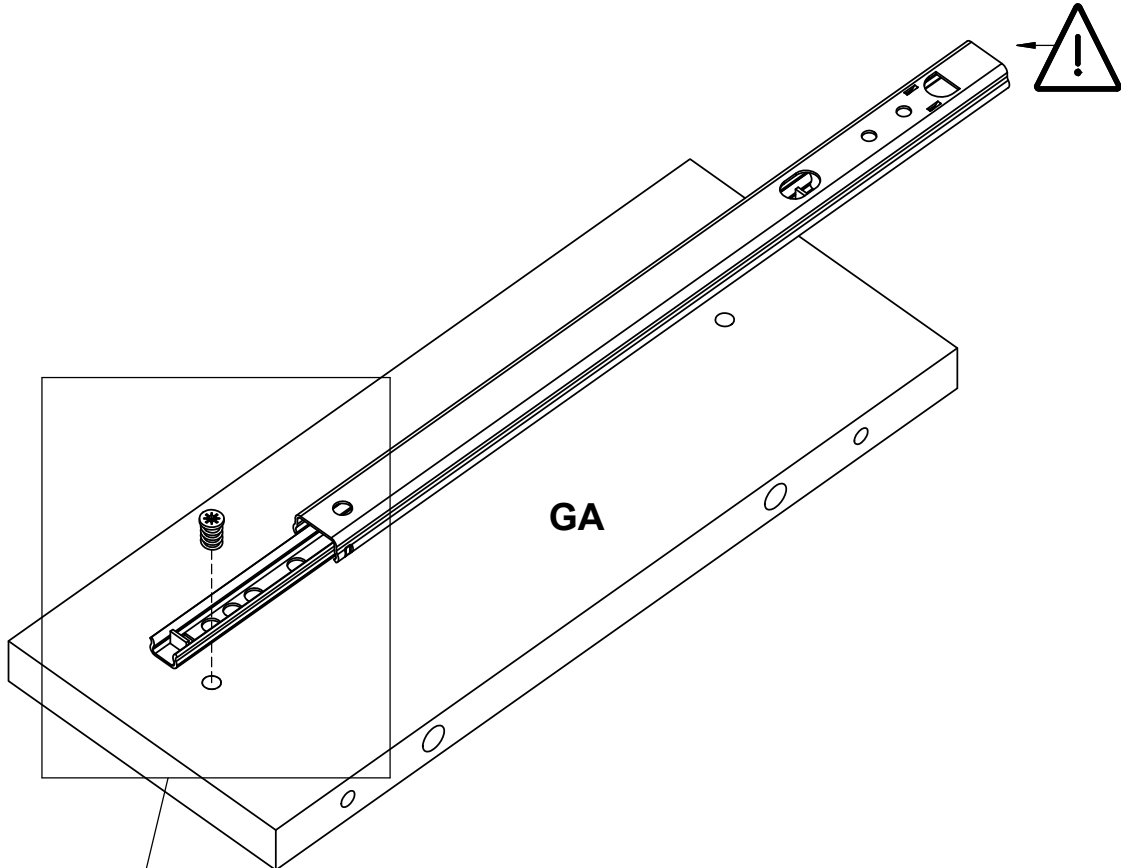
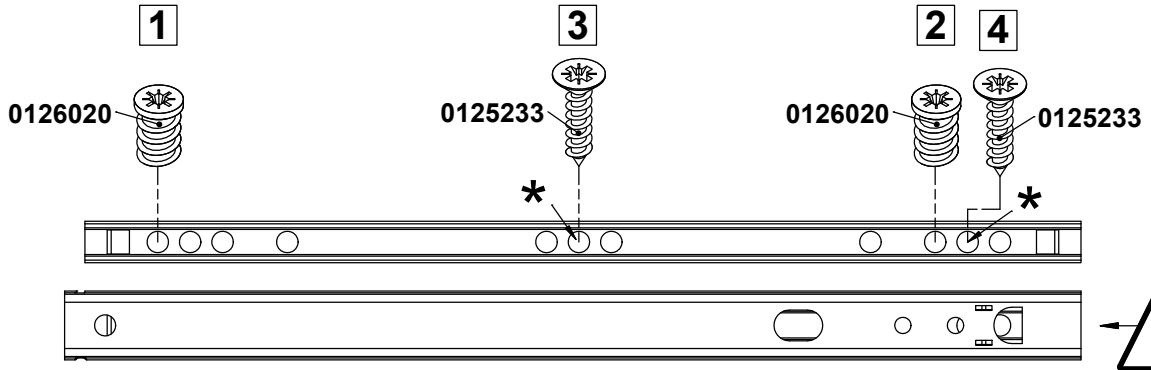
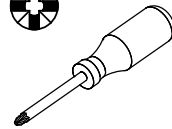
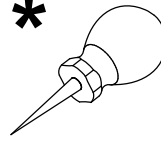

# 6

0125233

x2

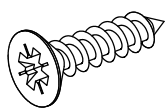

Ø0.14x0.59"  
Ø3,5x15 mm

0126020

x2

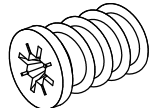

Ø0.23x0.35"  
Ø5,8x9 mm

0141403

x1

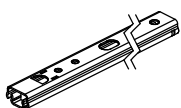

0.67x9.69/9.88"  
17x246/251 mm

\*

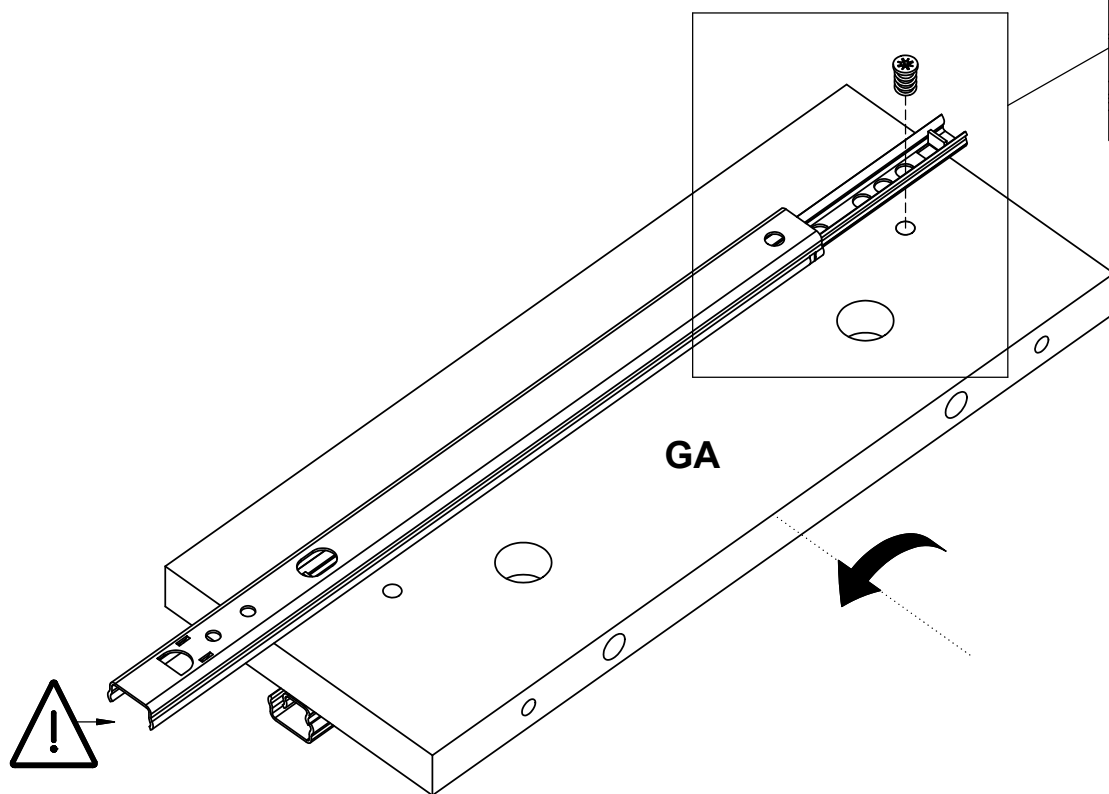
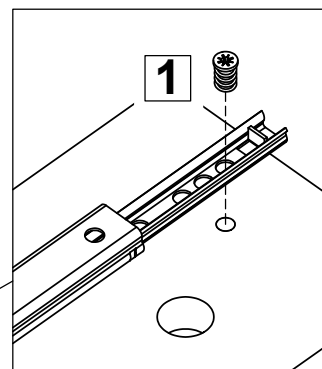
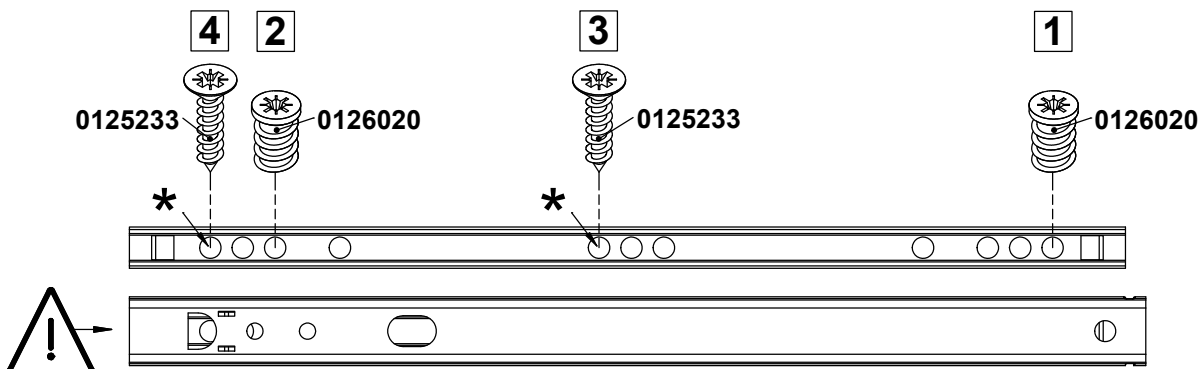
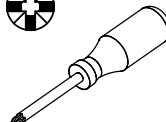
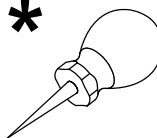

7

0120203

x2

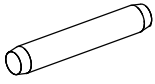

Ø0.2x1.18"  
Ø5x30 mm

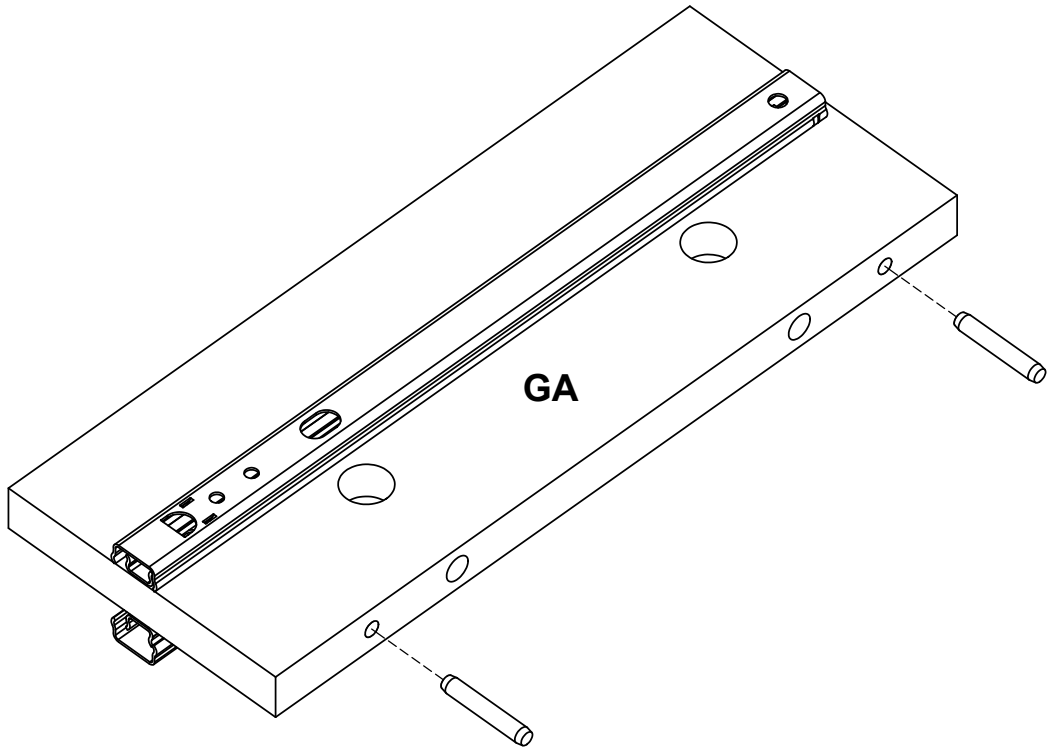
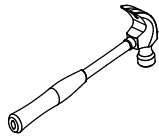

8

0120203

x8

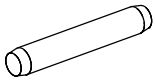

Ø0.2x1.18"  
Ø5x30 mm

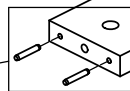
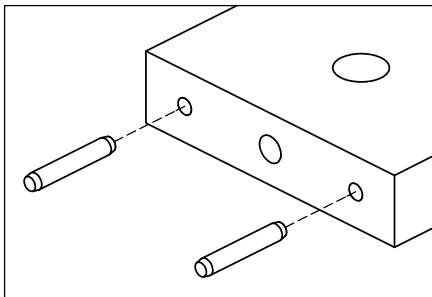
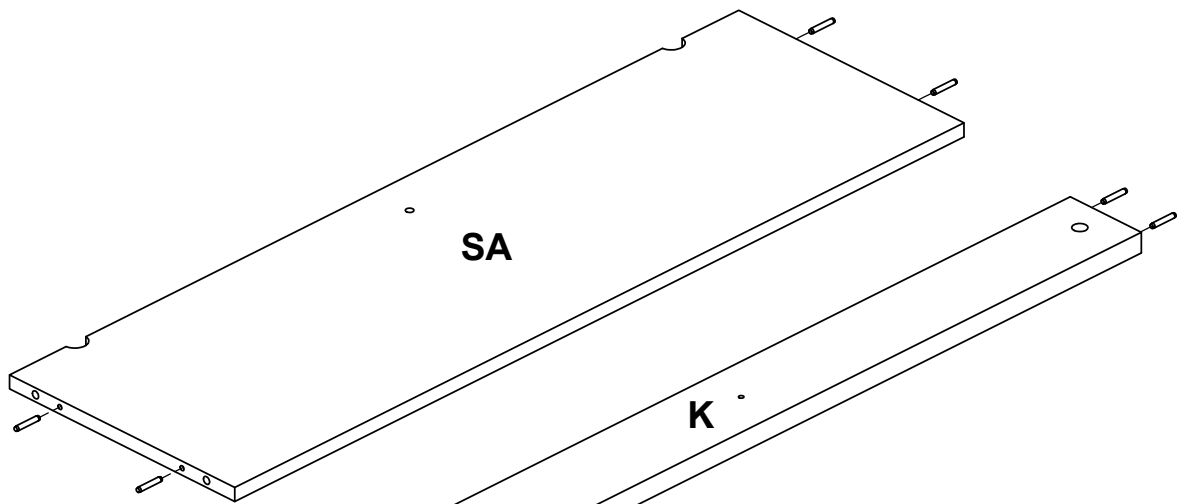
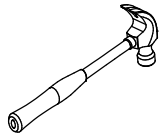

# 9

0131513

x6

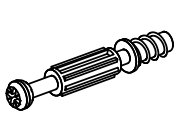

Ø0.30x1.73/1.34"  
Ø7,5x44/34 mm

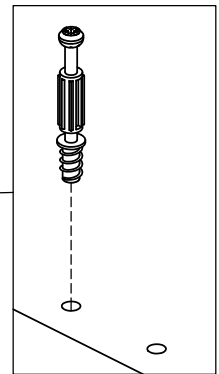
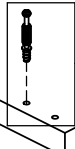
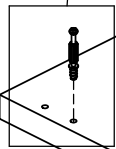
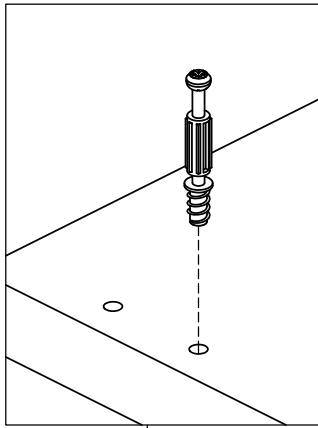
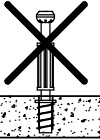
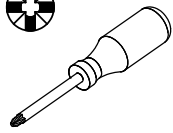

LA

# 10

0131687

x2

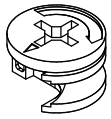

Ø0.59x0.37"  
Ø15x9,5 mm

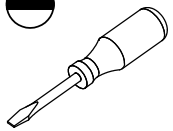

1

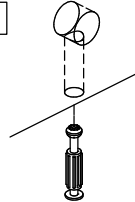

2

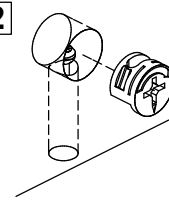

3

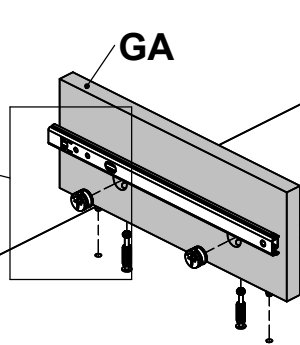
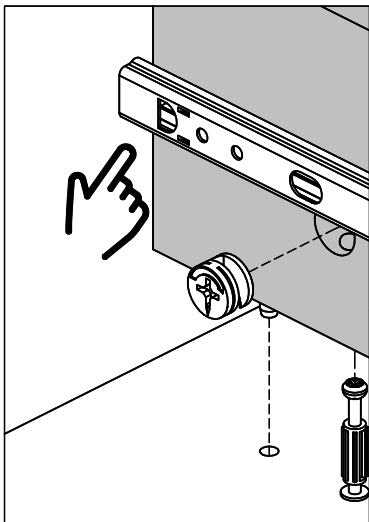
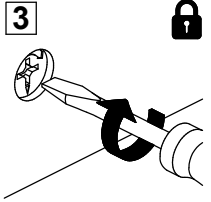

GA

LA

# 11

0131561

x4

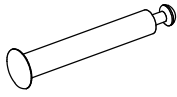

Ø0.28x2.02"  
Ø7x51,3 mm

0131687

x6

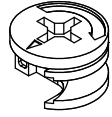

Ø0.59x0.37"  
Ø15x9,5 mm

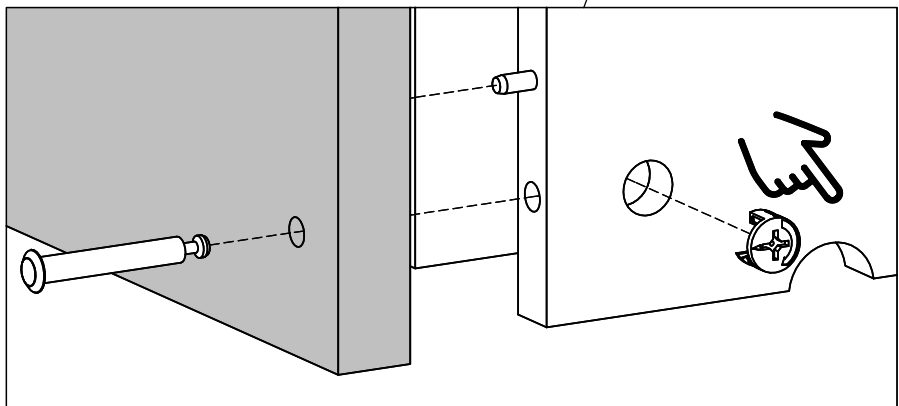
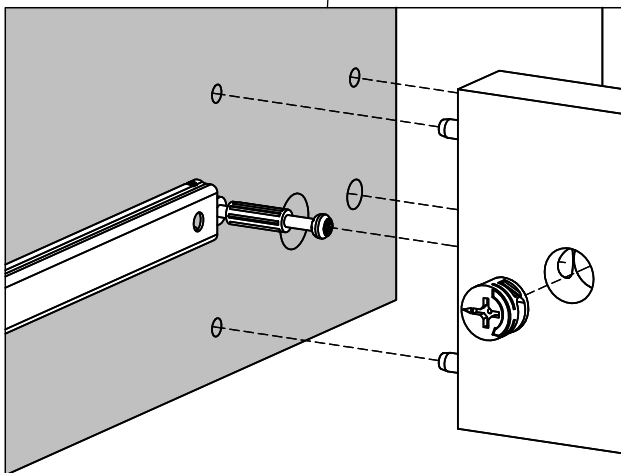
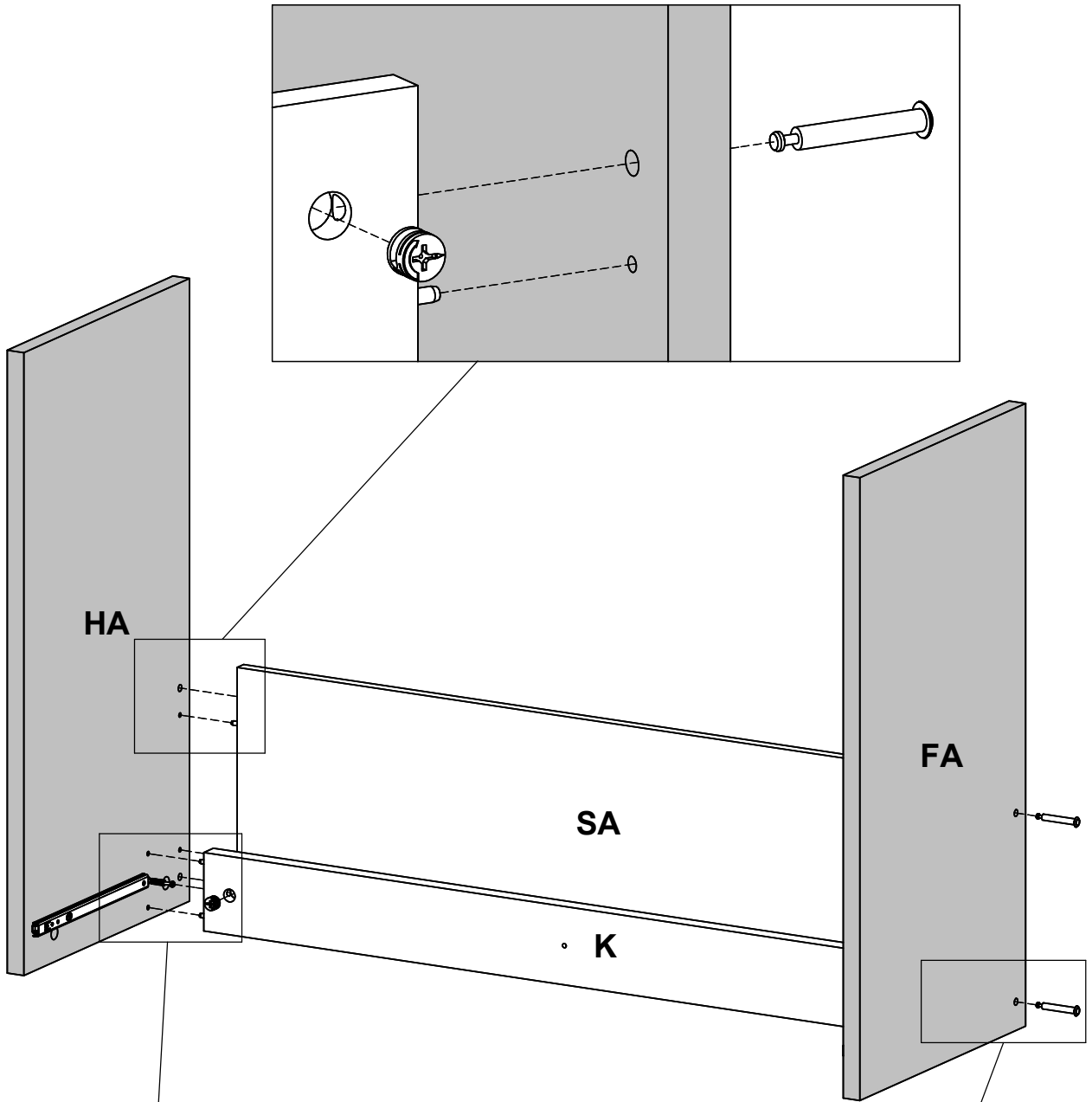
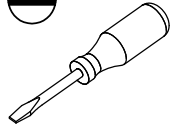

# 12

0163001

x4

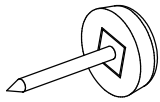

Ø0.47x0.16"  
Ø12x4 mm

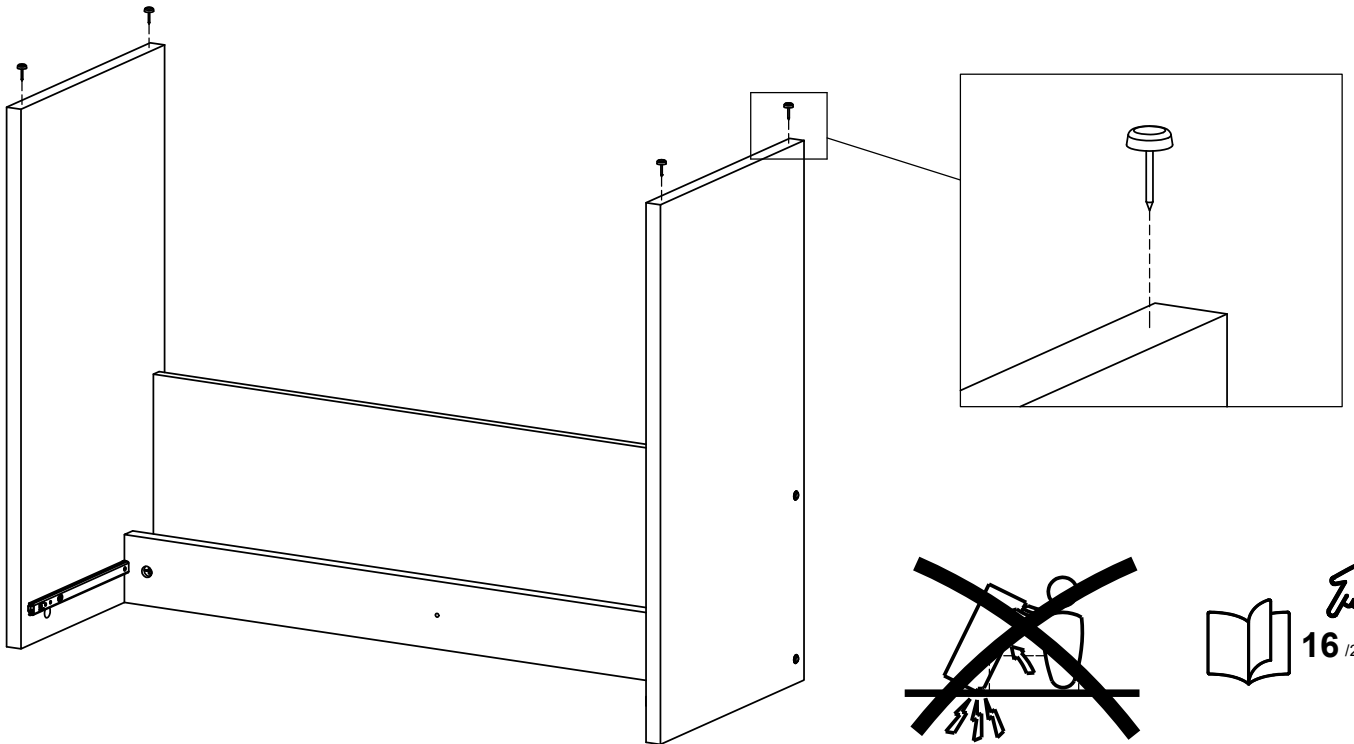
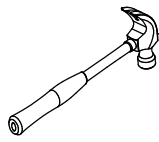

# 13

0120203

x4

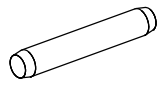

Ø0.2x1.18"  
Ø5x30 mm

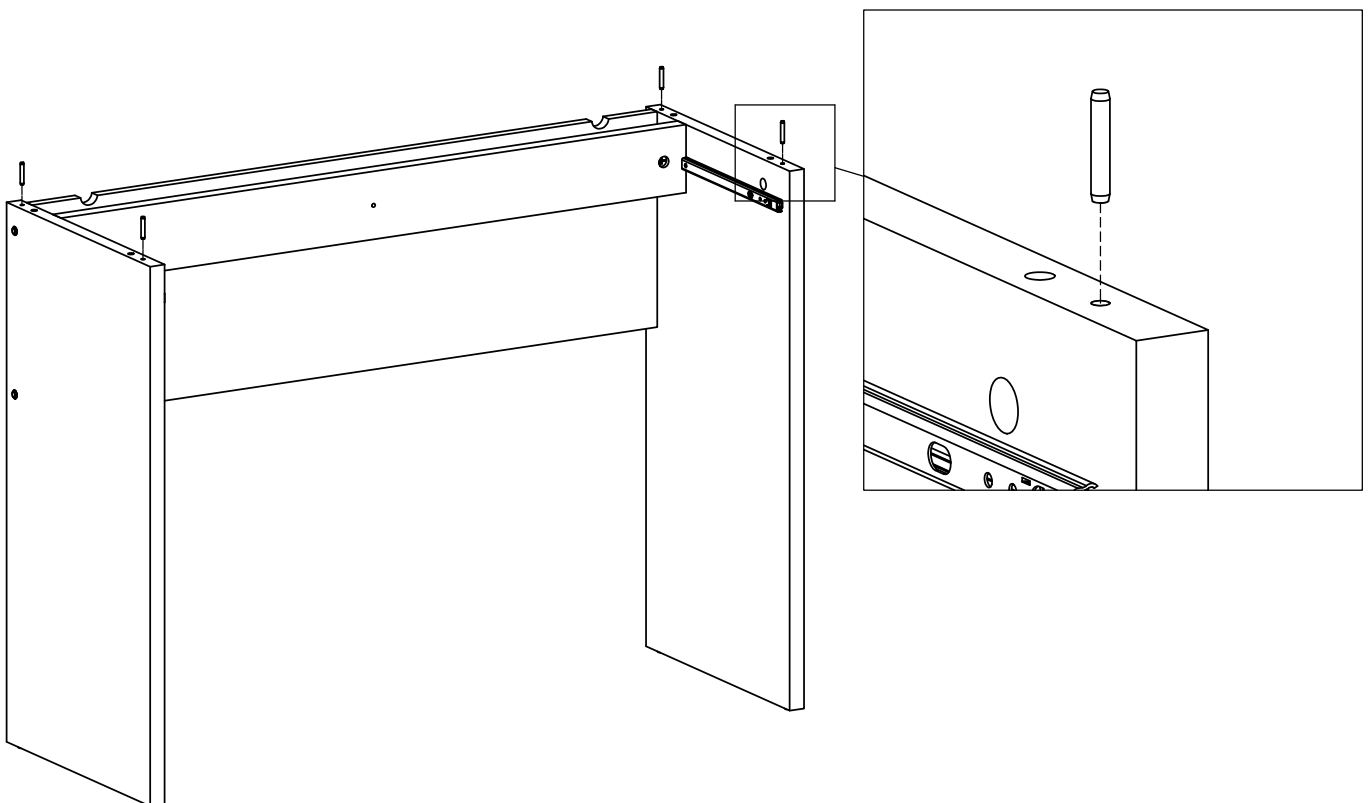
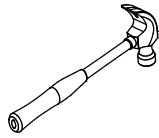

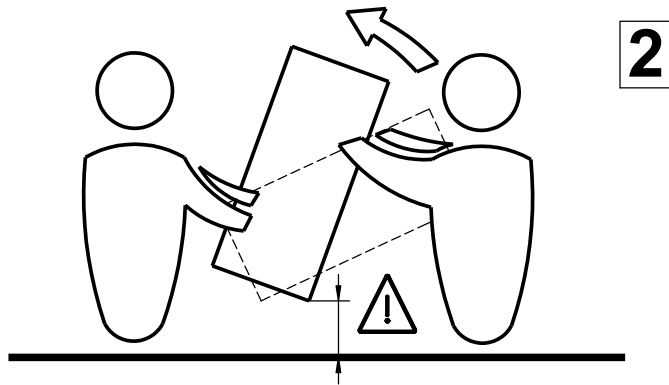
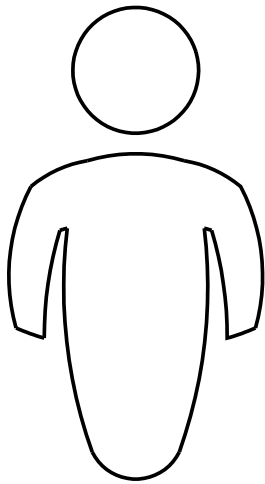
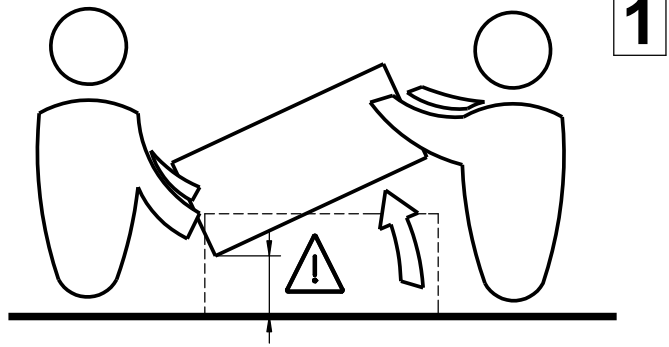
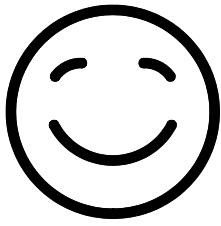
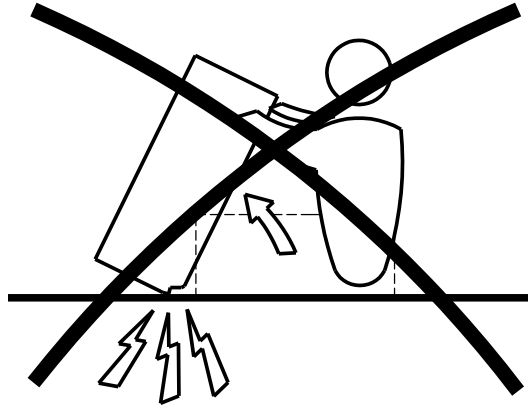
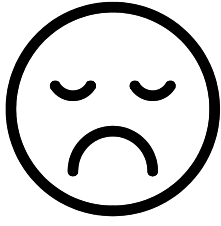

x2

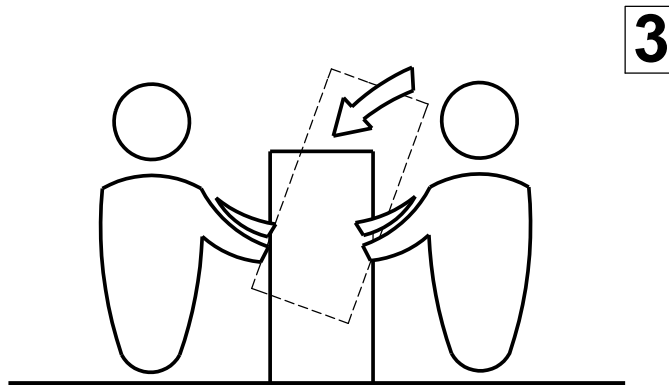

# 14

0131687

x4

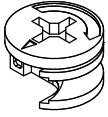

Ø0.59x0.37"  
Ø15x9,5 mm

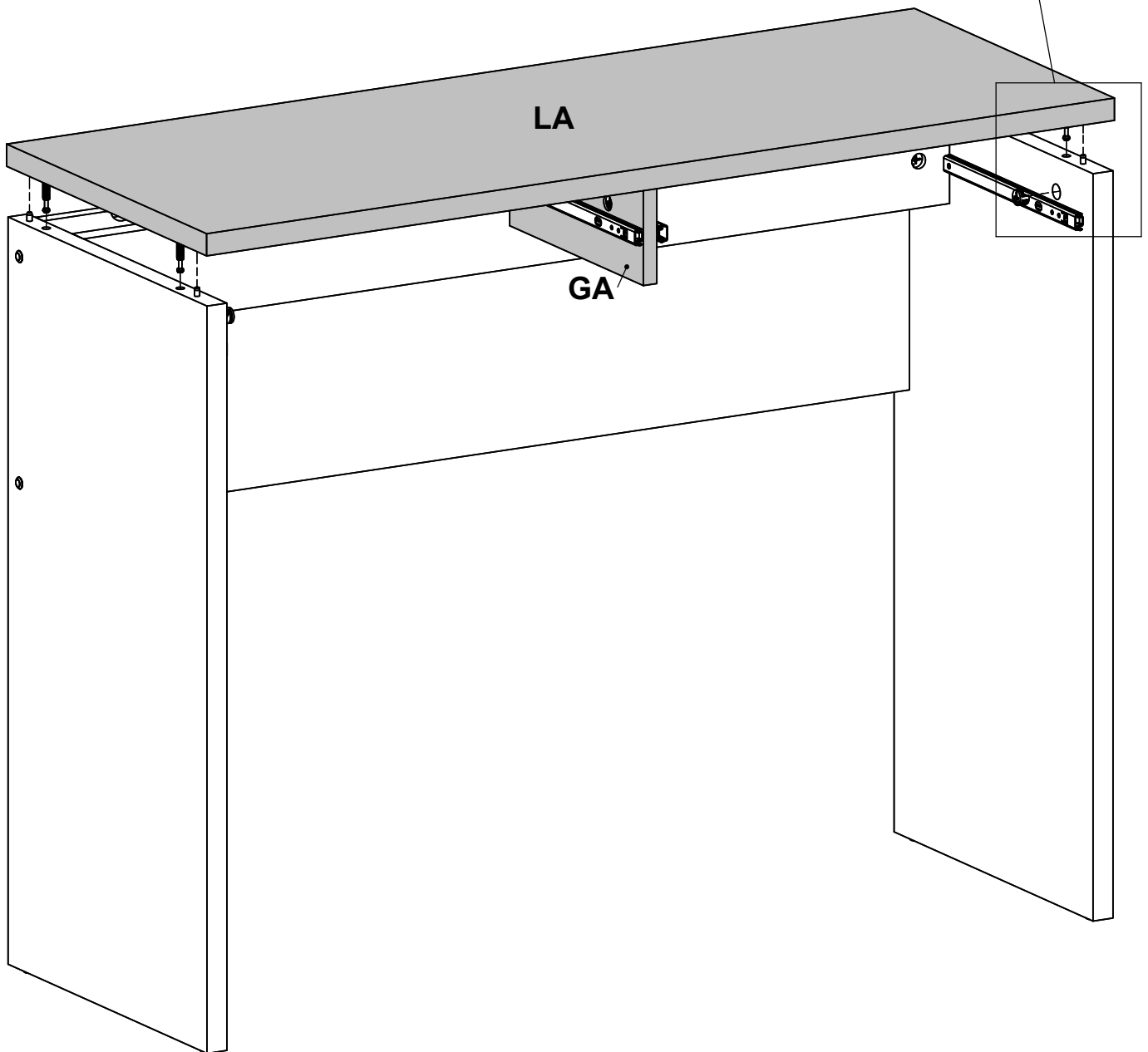
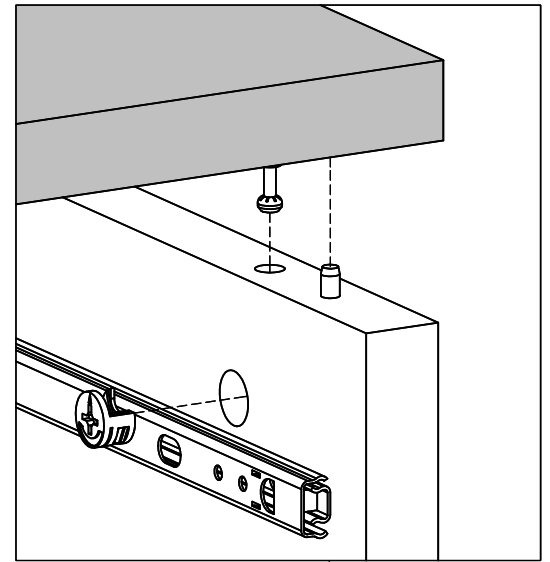
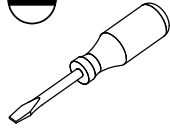

# 15

0125288

x1

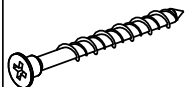

Ø0.18x1.77"  
Ø4,5x45 mm

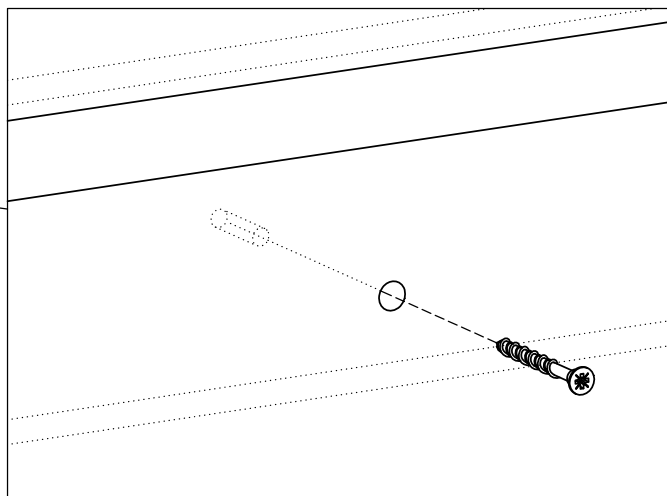
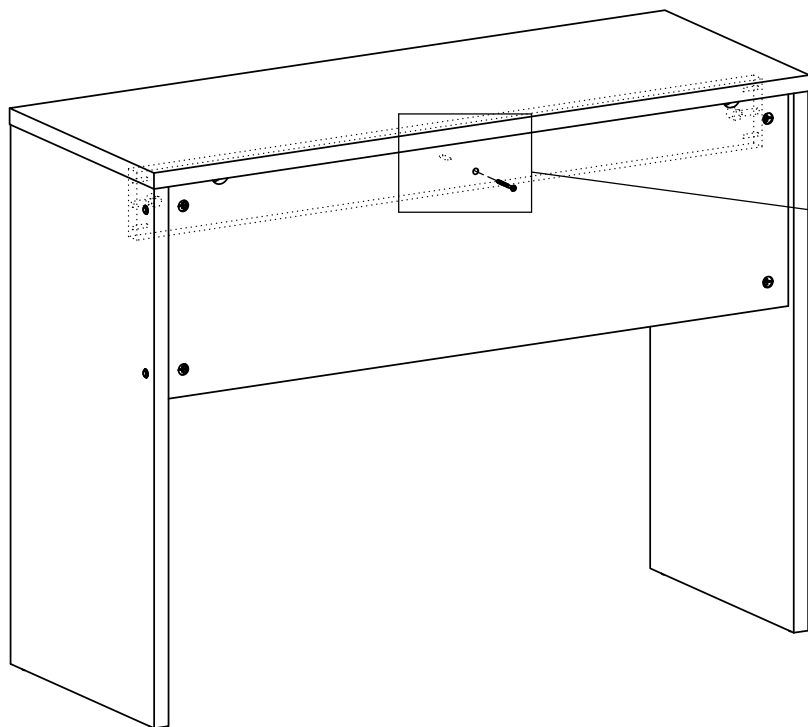

# 16

0110901

x4



Ø0.87x0.02"  
Ø22x0,5 mm

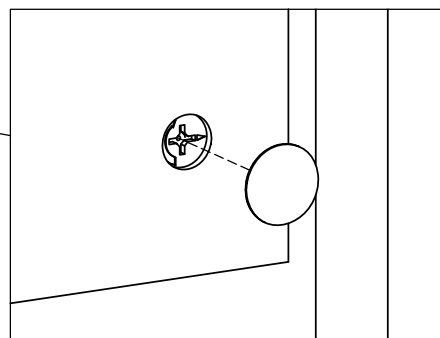
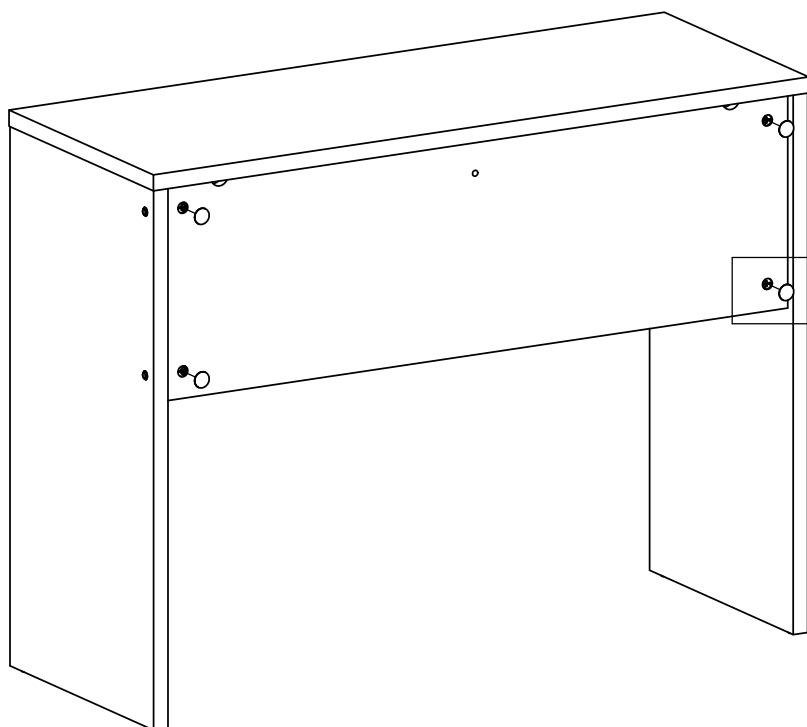

# 17

0194009

x2

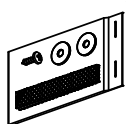

1.97x3.54x0.47"  
50x90x12 mm

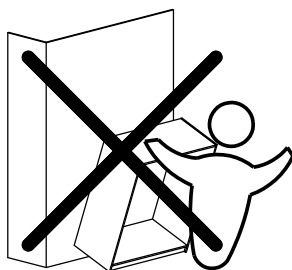
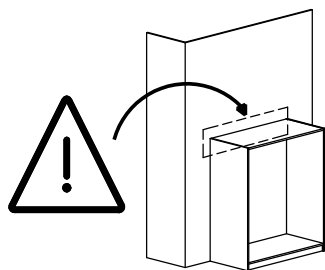
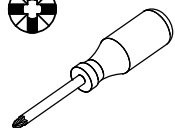

23 /28

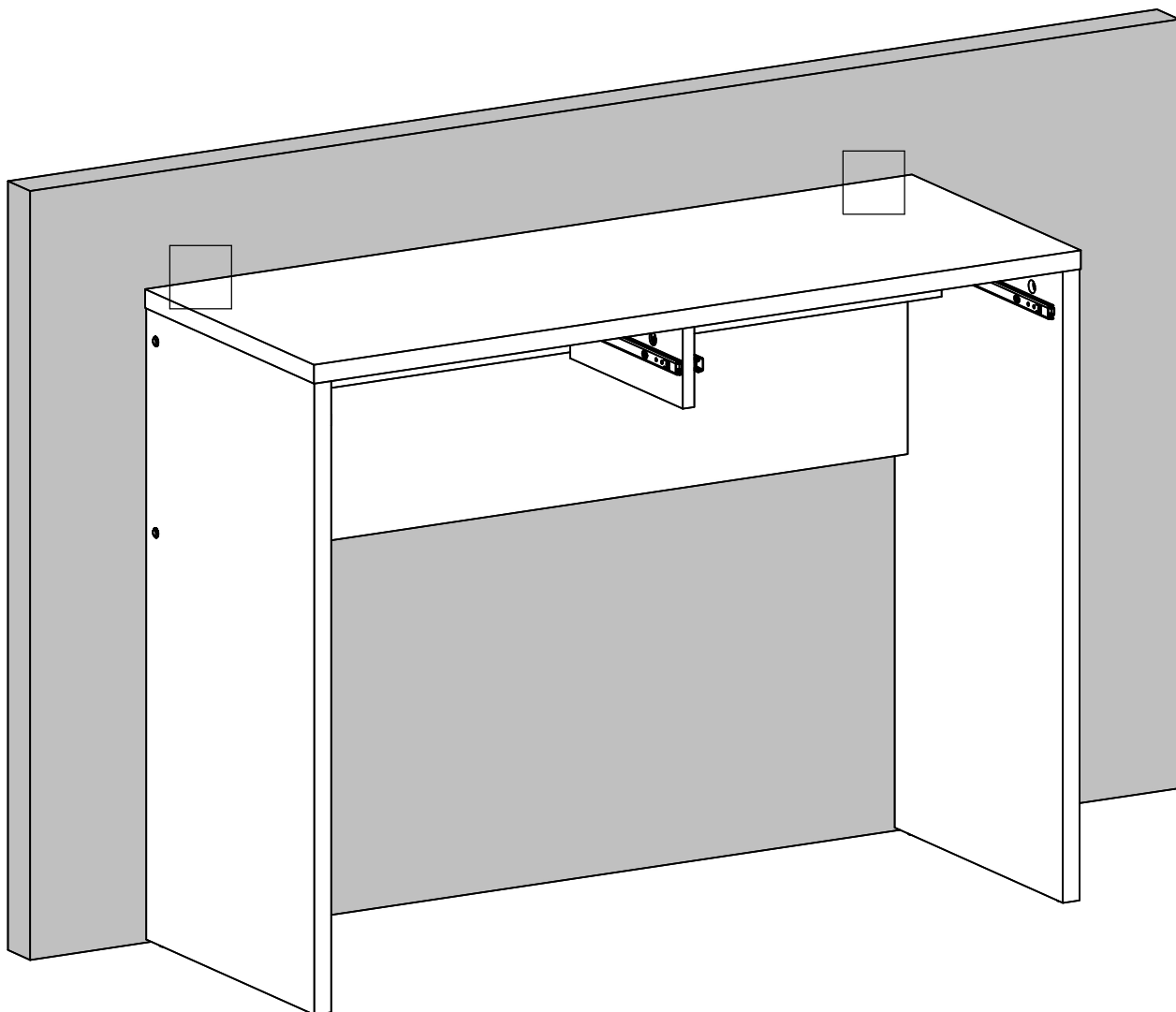

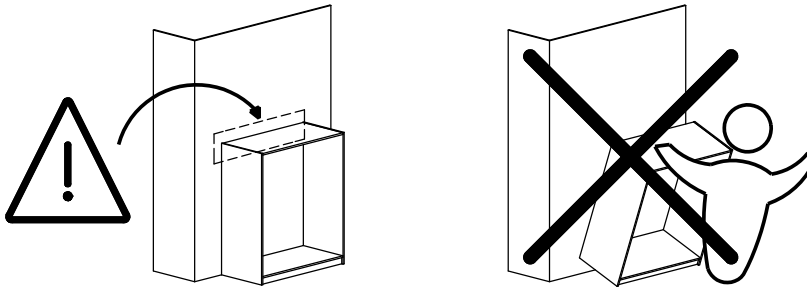

<p><b>1</b></p> <p>Diagram showing a small rectangular box being positioned against the side of a larger vertical frame. An arrow points to the left, indicating the direction of insertion.</p>	<p><b>2</b></p> <p>Diagram showing a pencil being used to mark a horizontal line on a wall surface. Below the line, a circular hole is being marked with a dotted line.</p>	<p><b>3</b></p> <p>Diagram showing the small rectangular box fully inserted into the larger vertical frame. An arrow points to the left.</p>
<p><b>4</b></p> <p>Diagram showing a pencil marking a vertical line on a wall. A dimension line indicates a distance of 30mm (1 1/5") from the top of the wall to the hole.</p>	<p><b>5</b></p> <p>Diagram showing a hand using a power drill to drill a hole into the wall. A question mark is placed above the drill bit.</p>	<p><b>6</b></p> <p>Diagram showing a hand using a screwdriver to insert a long, cylindrical anchor into the hole drilled in the wall. A question mark is placed above the anchor.</p>
<p><b>7</b></p> <p>Diagram showing a hand using a screwdriver to insert a screw into the anchor that has been placed in the wall.</p>	<p><b>8</b></p> <p>Diagram showing a hand using a screwdriver to attach a metal L-shaped bracket to the wall. A question mark is placed below the bracket.</p>	<p><b>9</b></p> <p>Diagram showing the small rectangular box fully inserted into the larger vertical frame, which is now mounted to the wall. An arrow points to the left.</p>
<p><b>10</b></p> <p>Close-up diagram showing the metal L-shaped bracket being secured to the wall with a screw.</p>	<p><b>11</b></p> <p>Diagram showing the small rectangular box inserted into the larger vertical frame. An arrow points to the left.</p>	<p><b>12</b></p> <p>Close-up diagram showing a hand using a screwdriver to tighten the screw that secures the bracket to the wall.</p>

# 18

0131513

x4

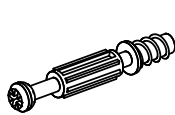

Ø0.30x1.73/1.34"  
Ø7,5x44/34 mm

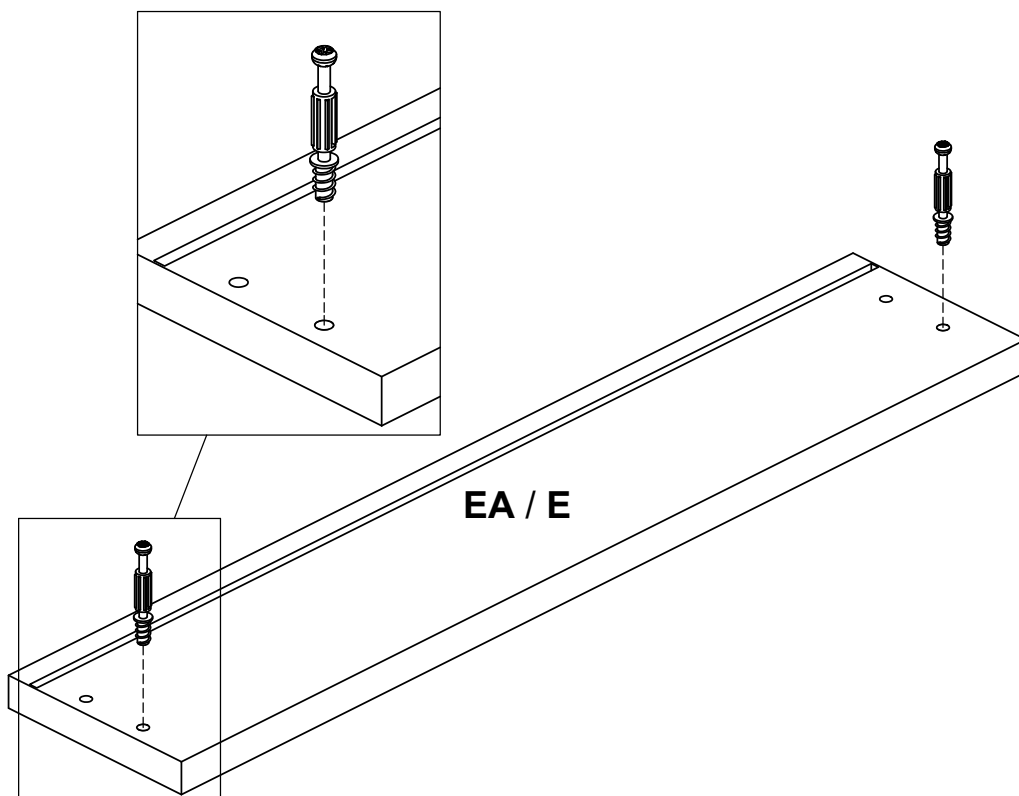
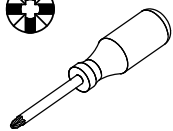

# 19

0120203

x4

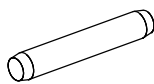

Ø0.2x1.18"  
Ø5x30 mm

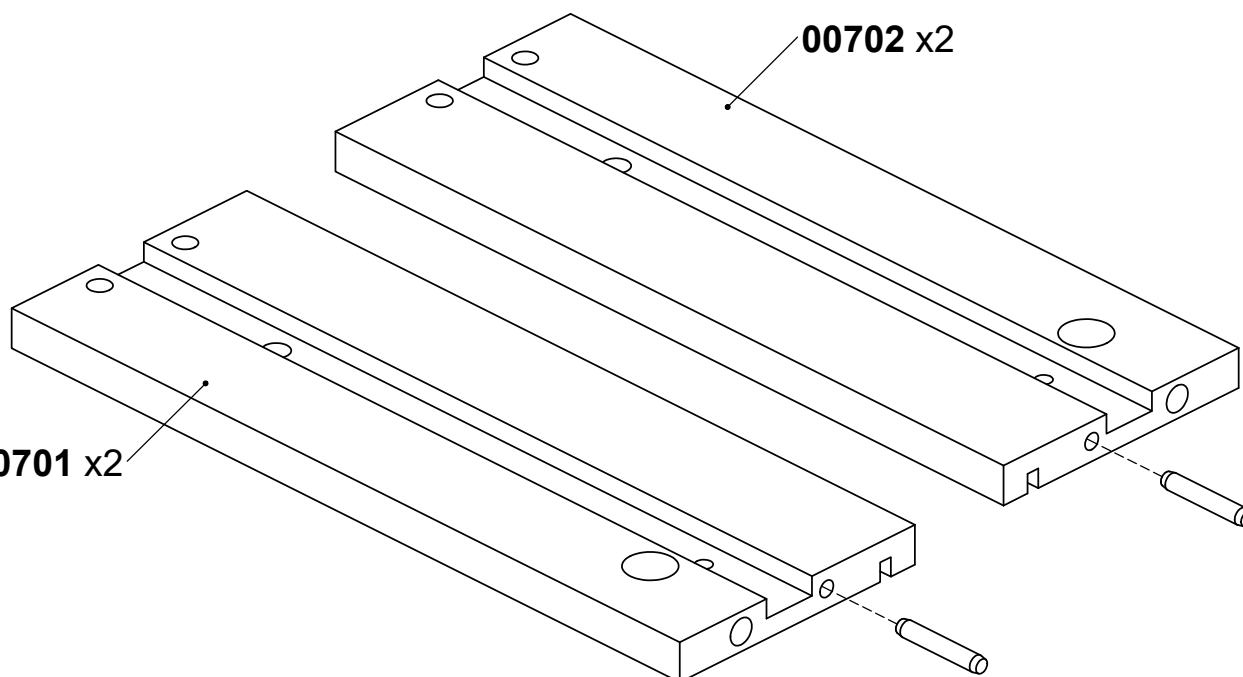
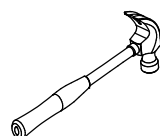

# 20

0131687

x4

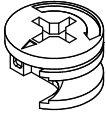

Ø0.59x0.37"  
Ø15x9,5 mm

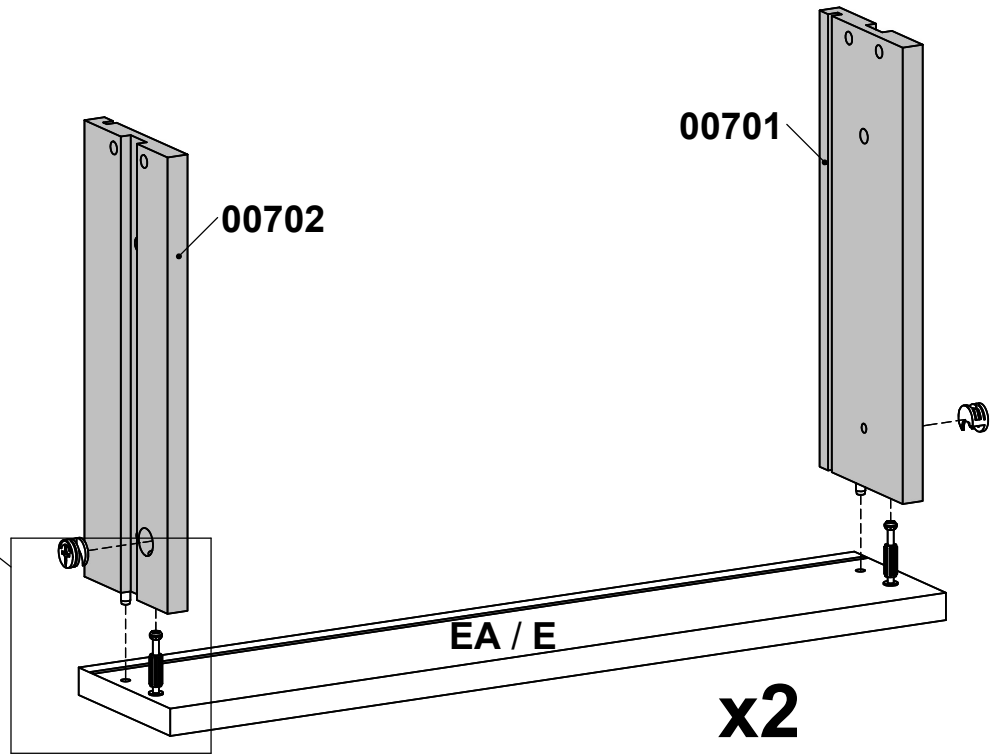
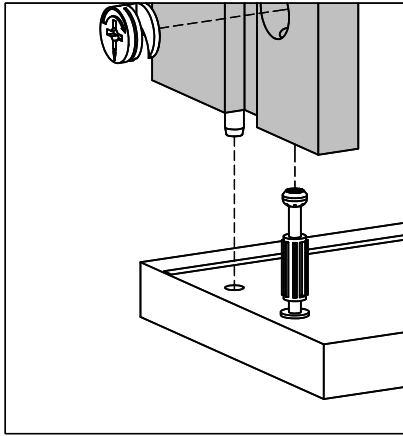
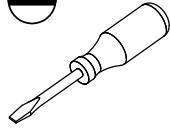

# 21

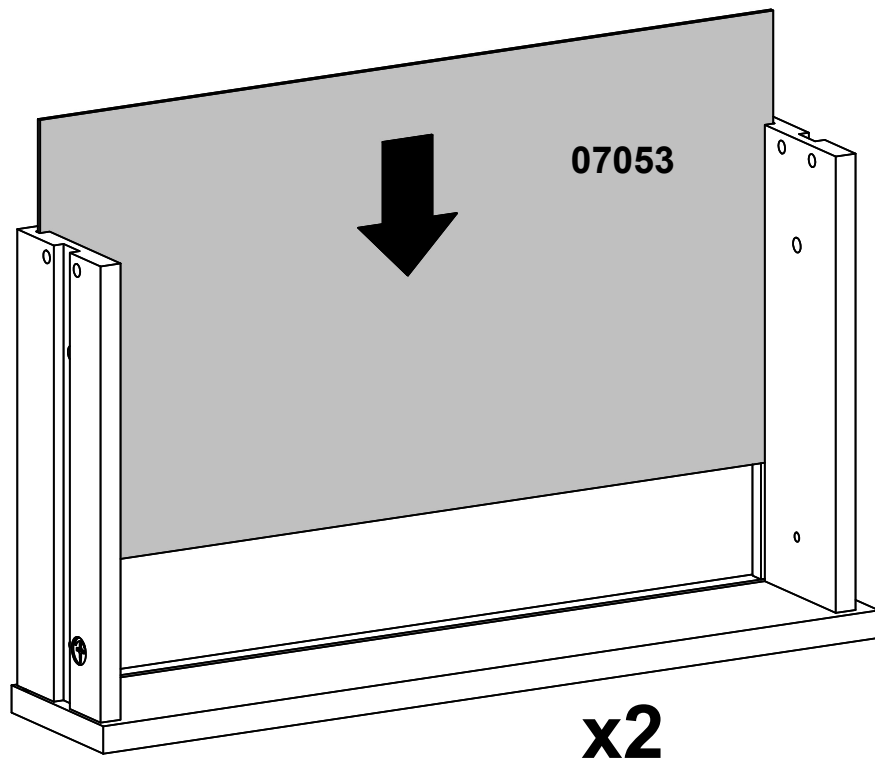

# 22

0120228

x8

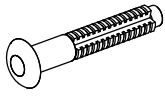

Ø0.25x1.57"  
Ø6,3x40 mm

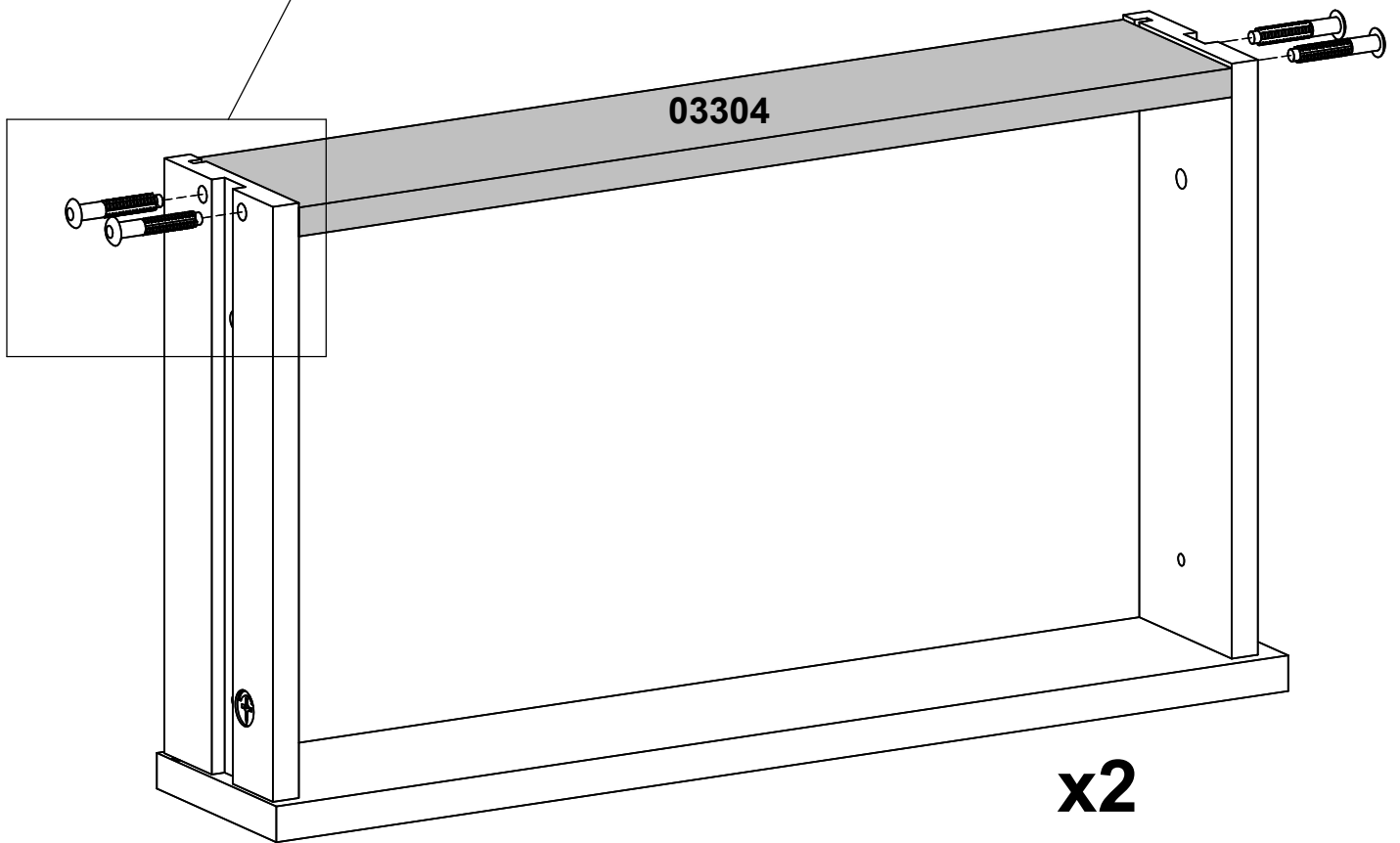
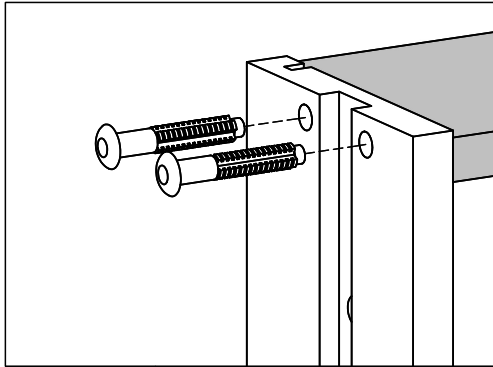
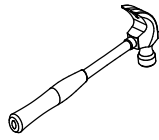

# 23

0126214

x4

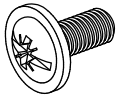

M4x0.35"  
M4x9 mm

